

This map is reproduced from the Ordnance Survey  
 material with the permission of Ordnance Survey on  
 behalf of the Controller of HMSO. Crown Copyright.  
 Unauthorised reproduction in any form is prohibited  
 and may lead to prosecution or civil proceedings.  
 Angus Council 10023404 - 2017

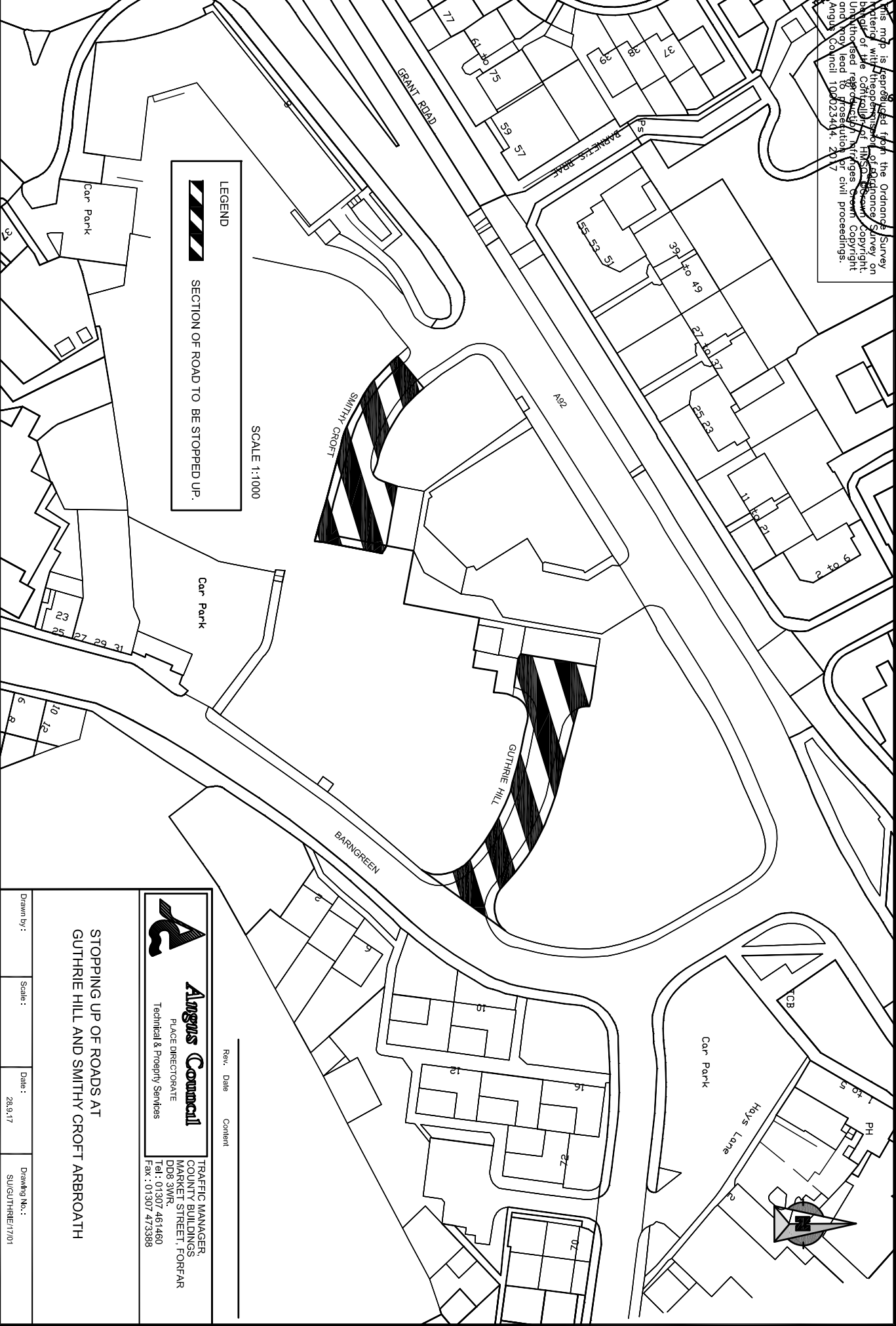

LEGEND



SECTION OF ROAD TO BE STOPPED UP.

SCALE 1:1000



**Angus Council**  
 PLACE DIRECTORATE  
 Technical & Property Services

TRAFFIC MANAGER,  
 COUNTY BUILDINGS,  
 MARKET STREET, FORTAR,  
 DD8 3WR,  
 Tel: 01307 461460  
 Fax: 01307 473388

Rev.	Date	Content

STOPPING UP OF ROADS AT  
 GUTTHRIE HILL AND SMITTHY CROFT ARBRATH

Drawn by:	Scale:	Date:	Drawing No.:
		28.9.17	SU/GUTTHRIE/1701