

© Crown copyright. All rights reserved. 100023404. 2017

**Location Plan**  
Scale 1:1250

**AREA coloured PINK**  
equals 227.8 square metres or thereby.

All dimensions in metres are thereby.

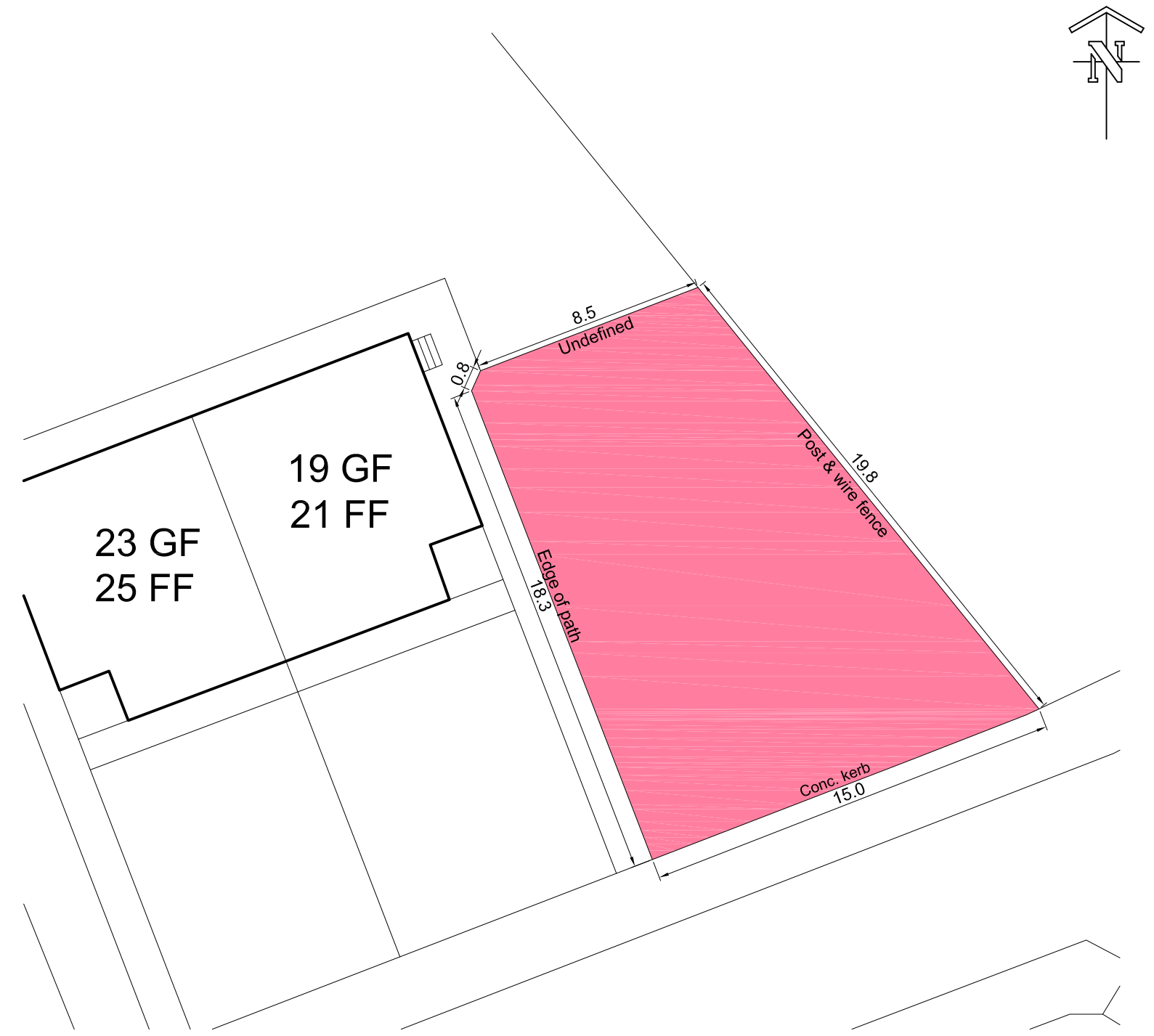

**Scale 1:200**

© Angus Council, Communities 2017



Communities  
William Wallace House  
Orchard Loan  
Orchardbank Business Park  
Forfar, DD8 1WH.  
Tel: 03452 777778

DATE DRAWN	22/10/17
DATE APPROVED	
FINAL PLAN	

19/21 Knowehead,  
Kirriemuir, DD8 5AL.

HP No.