

Appendix 2

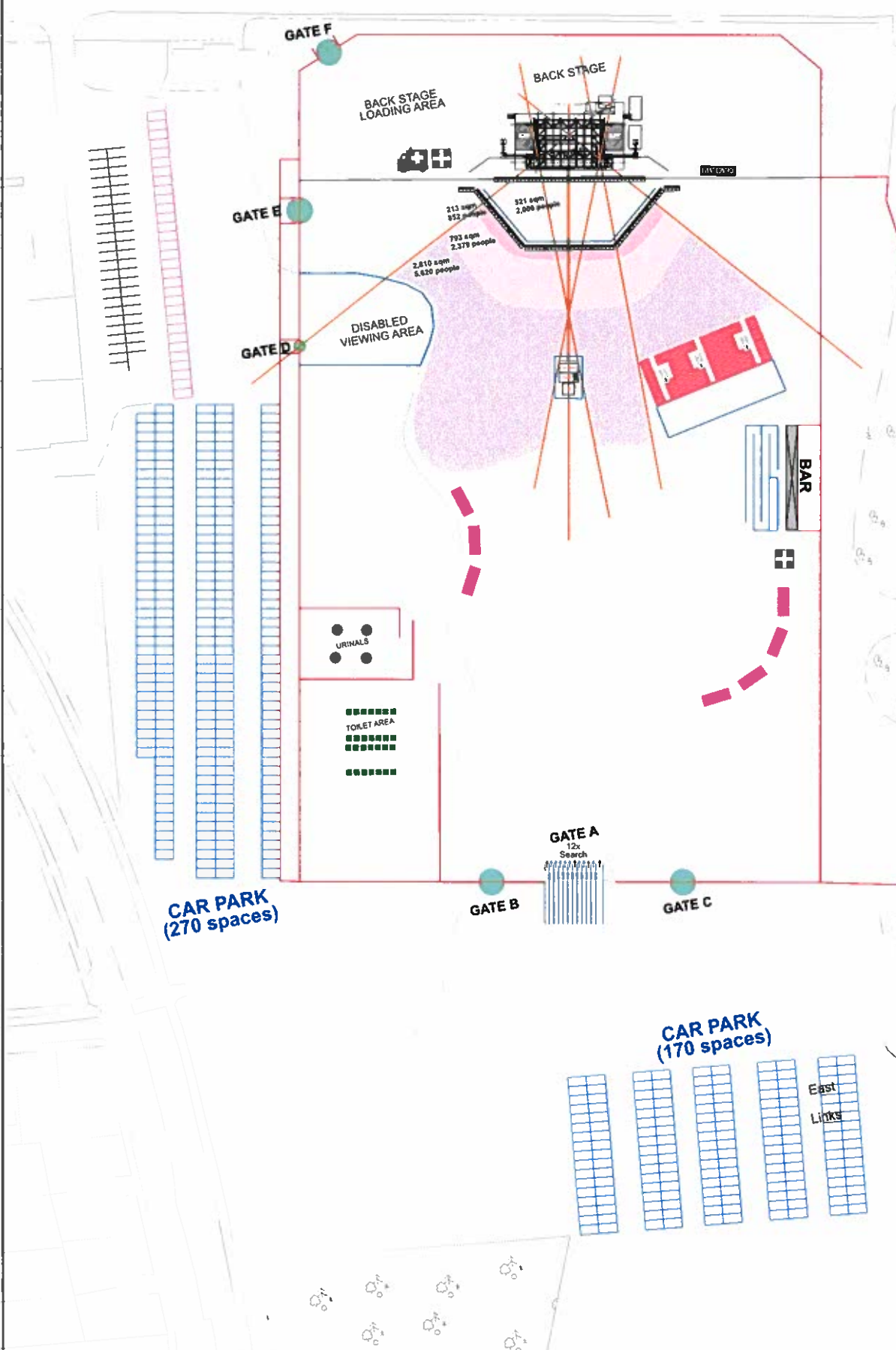

NOTES:

KEY:

- 2m HERAS FENCING
- 2m HERAS FENCING (SCRIMMED)
- 2.4m STEELSHEILD
- 1m CROWD BARRIER
- 1m CRUSH BARRIER
- EMERGENCY EXIT
- 9m LIGHTING TOWER 4x1600w
- LINK LIGHT 200w
- STEWARD POSITION
- RED ROUTE (EMG SERV)
- + FIRST AID
- + SEATING
- + PORTA CABIN
- + MARQUEE
- + WC's
- + PLACE OF SAFETY
- + GENERAL CAR PARK SPACE
- + DISABLED CAR PARK SPACE
- + COACH PARKING SPACE
- + GENERATOR
- + CABLE PROTECTOR
- + PITCH FLOORING

Rev	Drawn By	Scale	Stipus	Date
1	SF	1:1000 @ A3	PROPOSED	11.03.19

Project Title & Main Contractor
MONTROSE CONCERTS 2019
LCC LIVE EVENT SERVICES

Description
EVENT ARENA LAYOUT JESS GLYNNE
CONCERT AUGUST 23RD

RSS EVENTS
 Road Safety Services Limited
 2000 Woodlands Drive, Brisbane QLD 4101
 Tel: 08 2514 9338 Fax: 08 2514 9339
 Email: rsl@rss-events.com.au
 08 2514 9339

Drawing Ref:
 -101

BM 4.96m

Reproduced from the 'Event Safety Handbook' published by the Queensland Fire and Emergency Services (QFES) in 2018. This handbook is a guide to the minimum standards for event safety. It is not a substitute for professional advice. The handbook is a guide to the minimum standards for event safety. It is not a substitute for professional advice. The handbook is a guide to the minimum standards for event safety. It is not a substitute for professional advice.