

Item 6

Planning application:  
20/00019/FULM

East Ballochy, Dun

The Installation of a Solar  
Photovoltaic Array, a Battery  
Energy Storage System and a  
Private Wire Grid Connection  
and Associated Infrastructure  
for Scottish Power  
Renewables



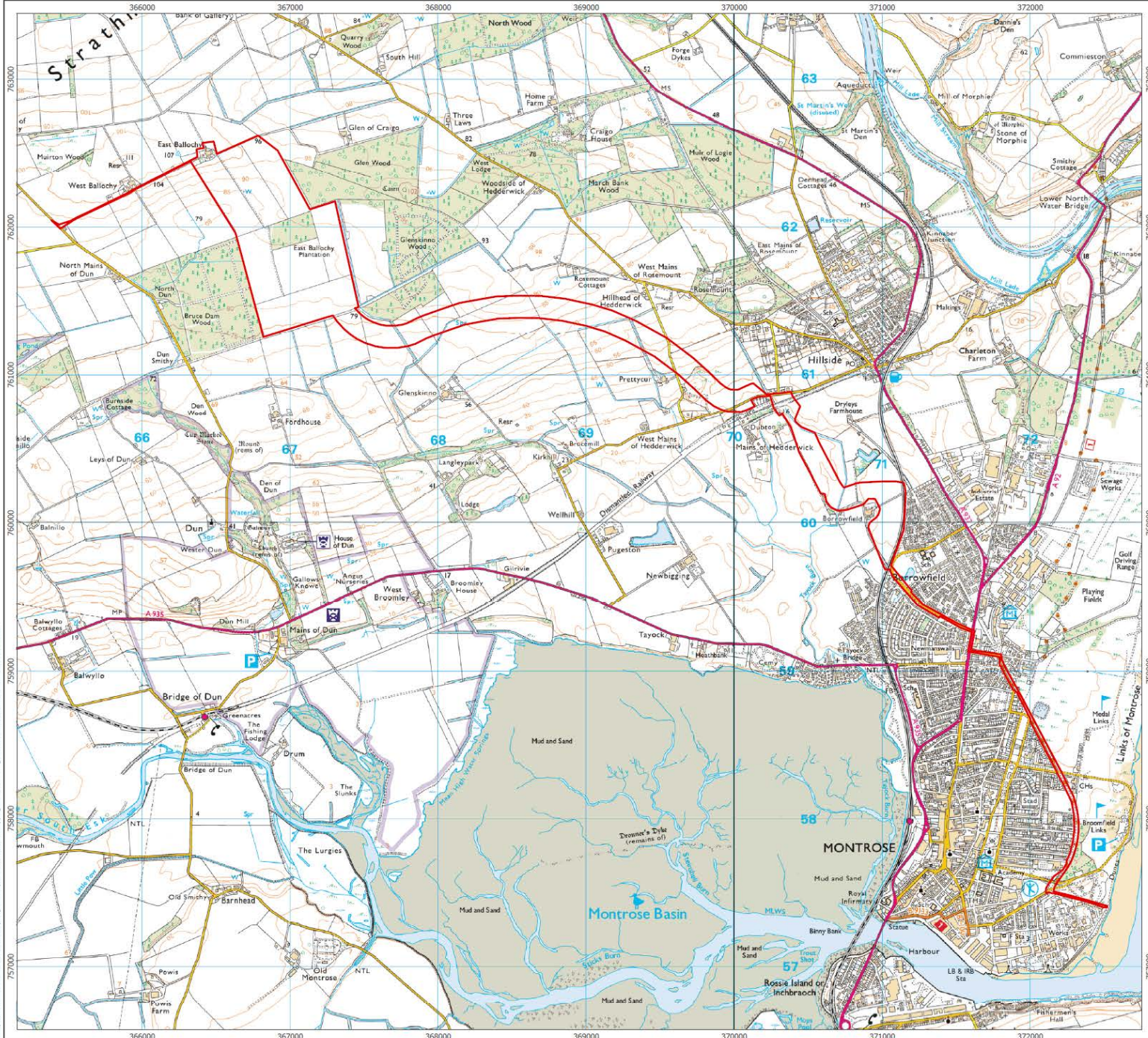

Reproduced from Ordnance Survey digital map data © Crown copyright 2020. All rights reserved. License number: 100048606  
 P:\Projects\Landscape\Projects\3370 Ballochly Solar Development\3370 Ballochly Solar Development.aprx\3370-REP-035 Fig. 1.1 Location Plan



Application Boundary

Application site =  
 161.63 ha ( 399.4  
 acres)

1:25,000 Scale @ A3  
 0 0.45 0.9 km

Produced By: KM	Ref: 3370-REP-034.
Checked By: KS	Date: 09/01/2020



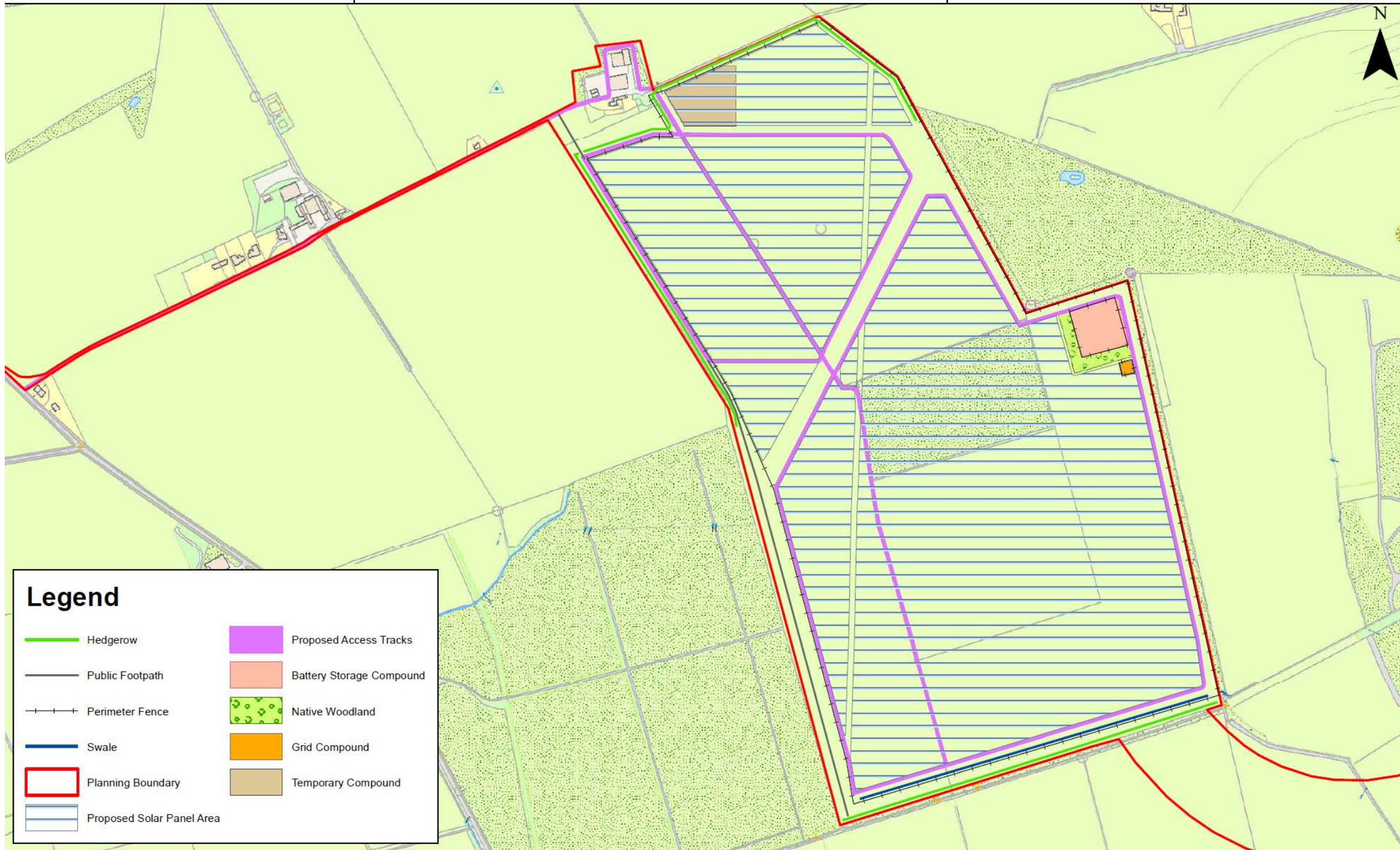

**Location Plan**  
 Figure 1.1

**Ballochly Solar Development  
 Planning Application**





### Legend

- |   |                           |   |                          |
|---|---------------------------|---|--------------------------|
|  | Hedgerow                  |  | Proposed Access Tracks   |
|  | Public Footpath           |  | Battery Storage Compound |
|  | Perimeter Fence           |  | Native Woodland          |
|  | Swale                     |  | Grid Compound            |
|  | Planning Boundary         |  | Temporary Compound       |
|  | Proposed Solar Panel Area |   |                          |

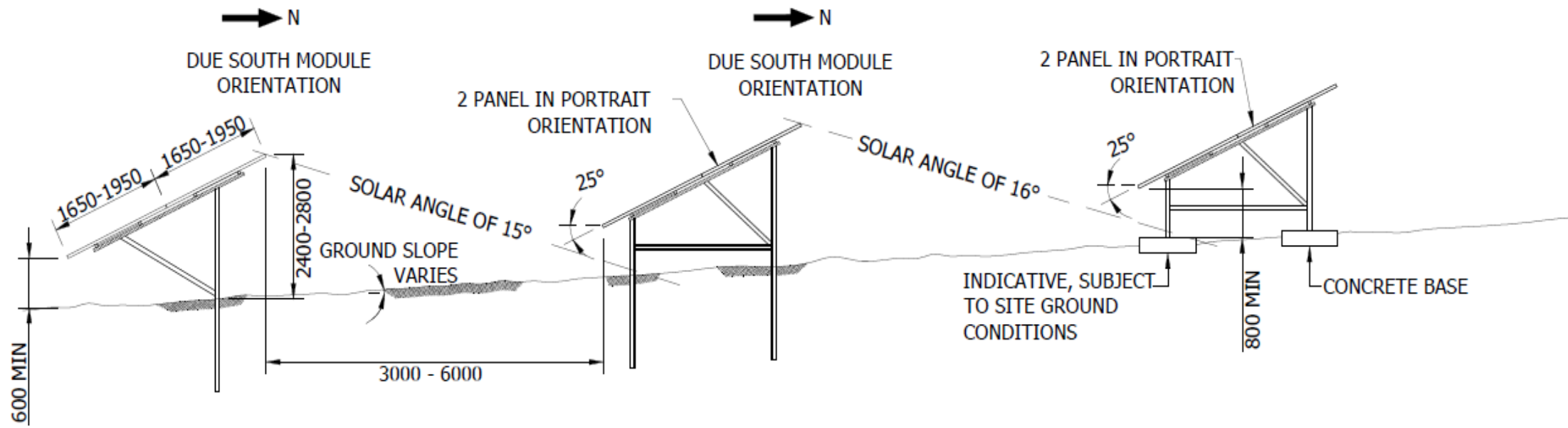

SINGLE POST TYPE

TABLE POST TYPE

TYPICAL SECTION THROUGH VARIOUS MODULE OPTIONS

CONCRETE BASE TYPE

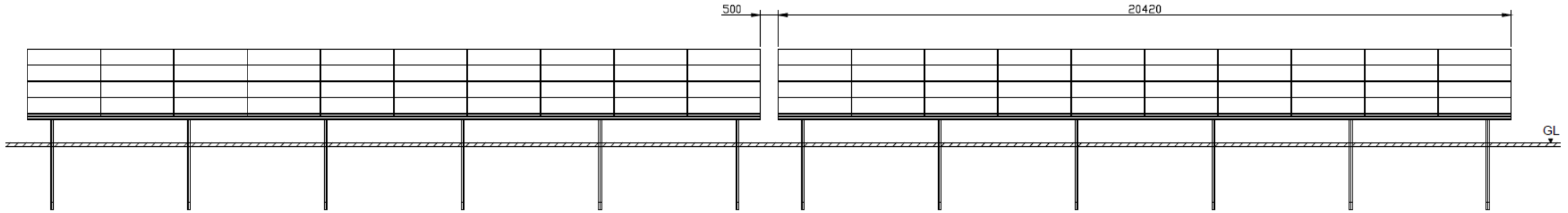



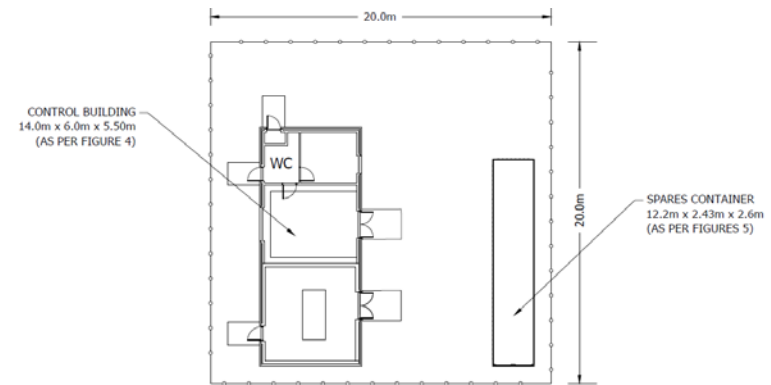
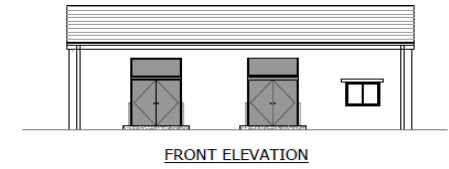
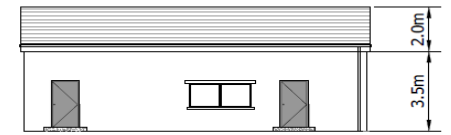
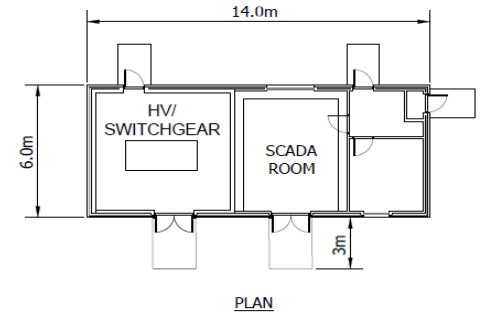
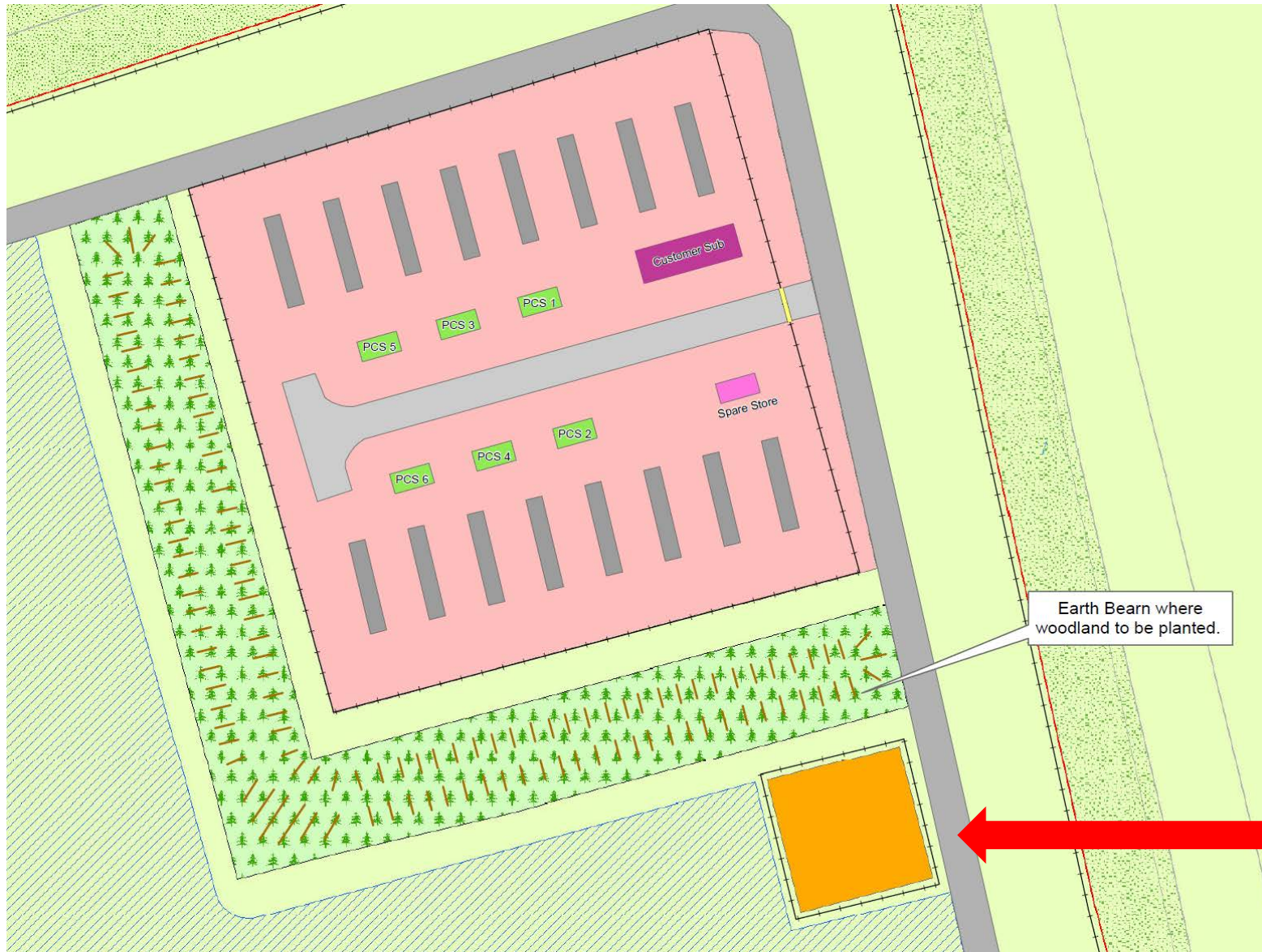

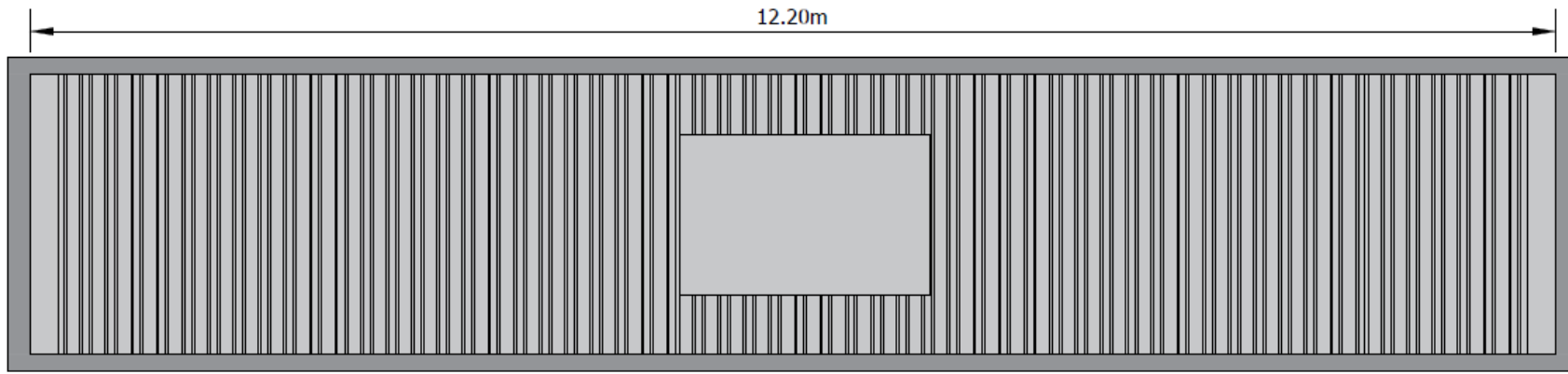

ROOF PLAN

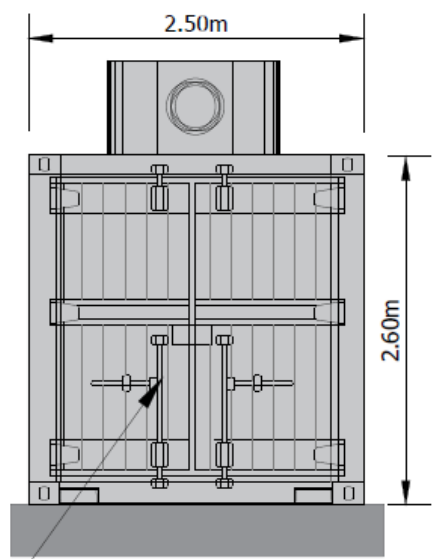

CONTAINER DOORS

EASTERN ELEVATION

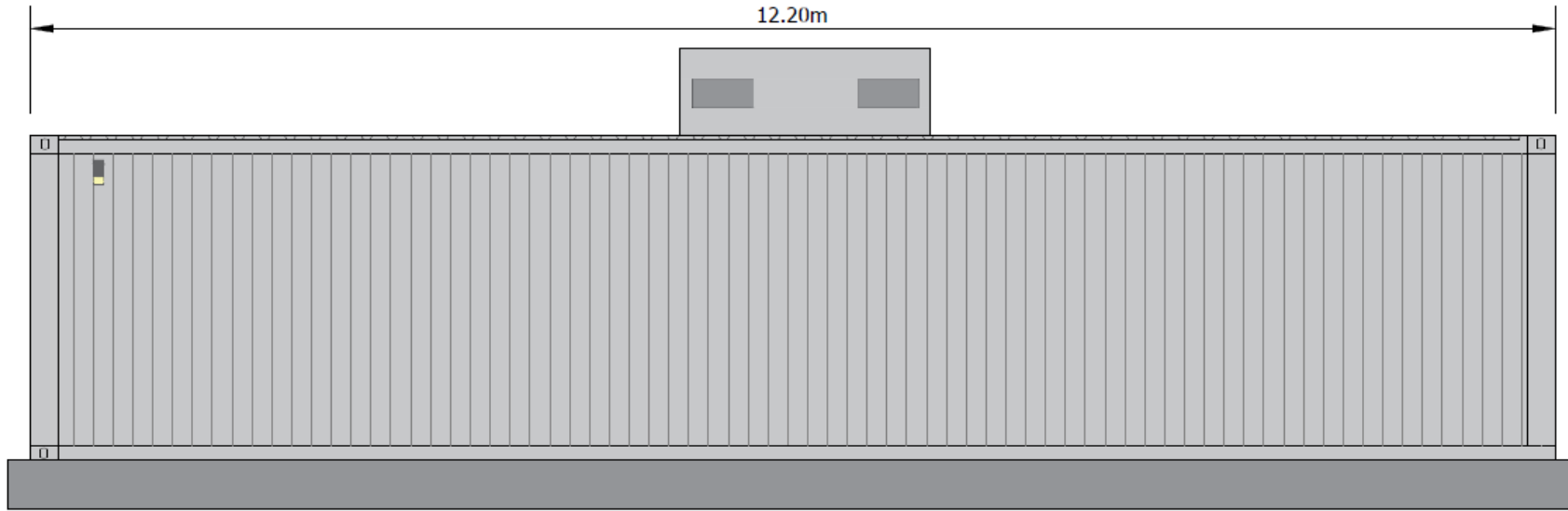

NORTHERN AND SOUTHERN ELEVATION

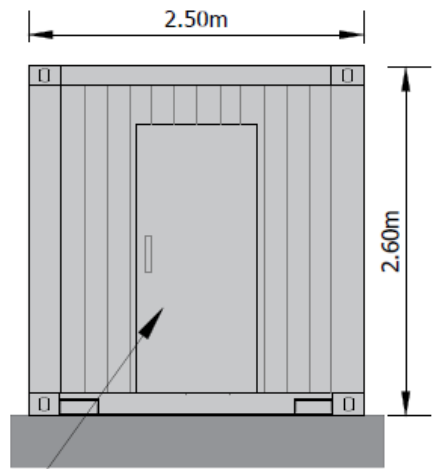

ESCAPE DOOR

WESTERN ELEVATION

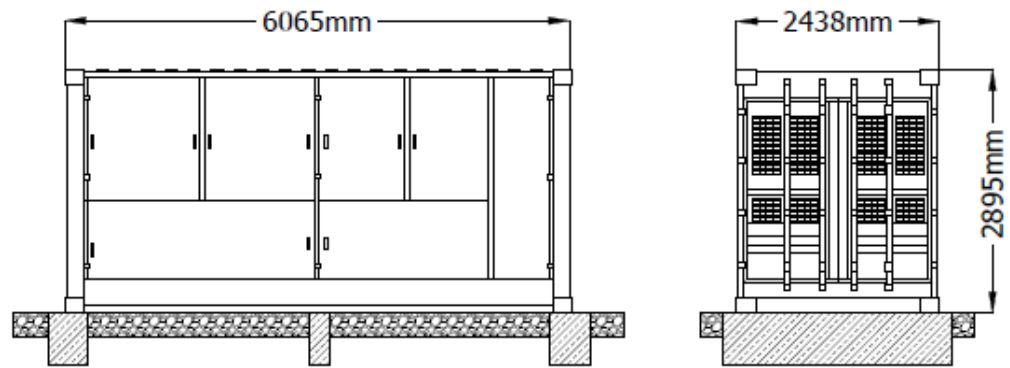

TYPICAL INVERTER SUBSTATION  
1:100

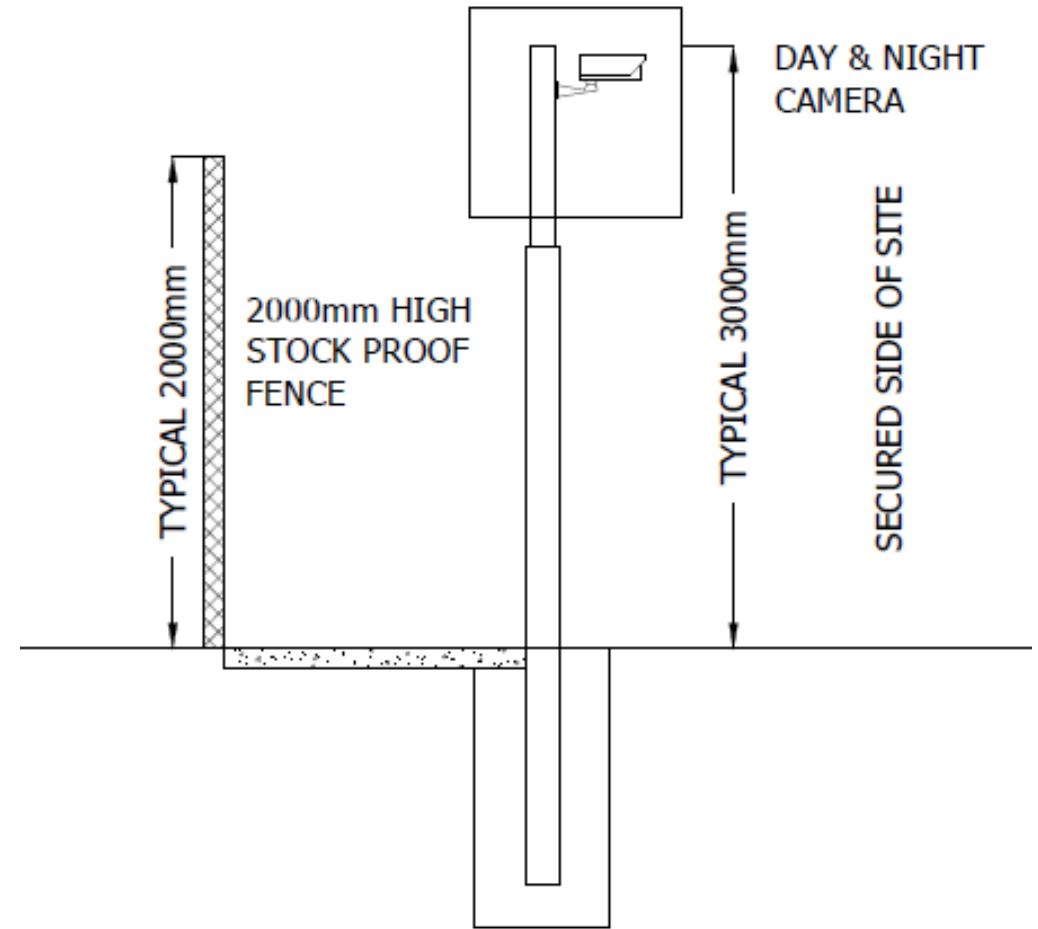

TYPICAL SECURITY COLUMN DETAIL  
SCALE 1:50



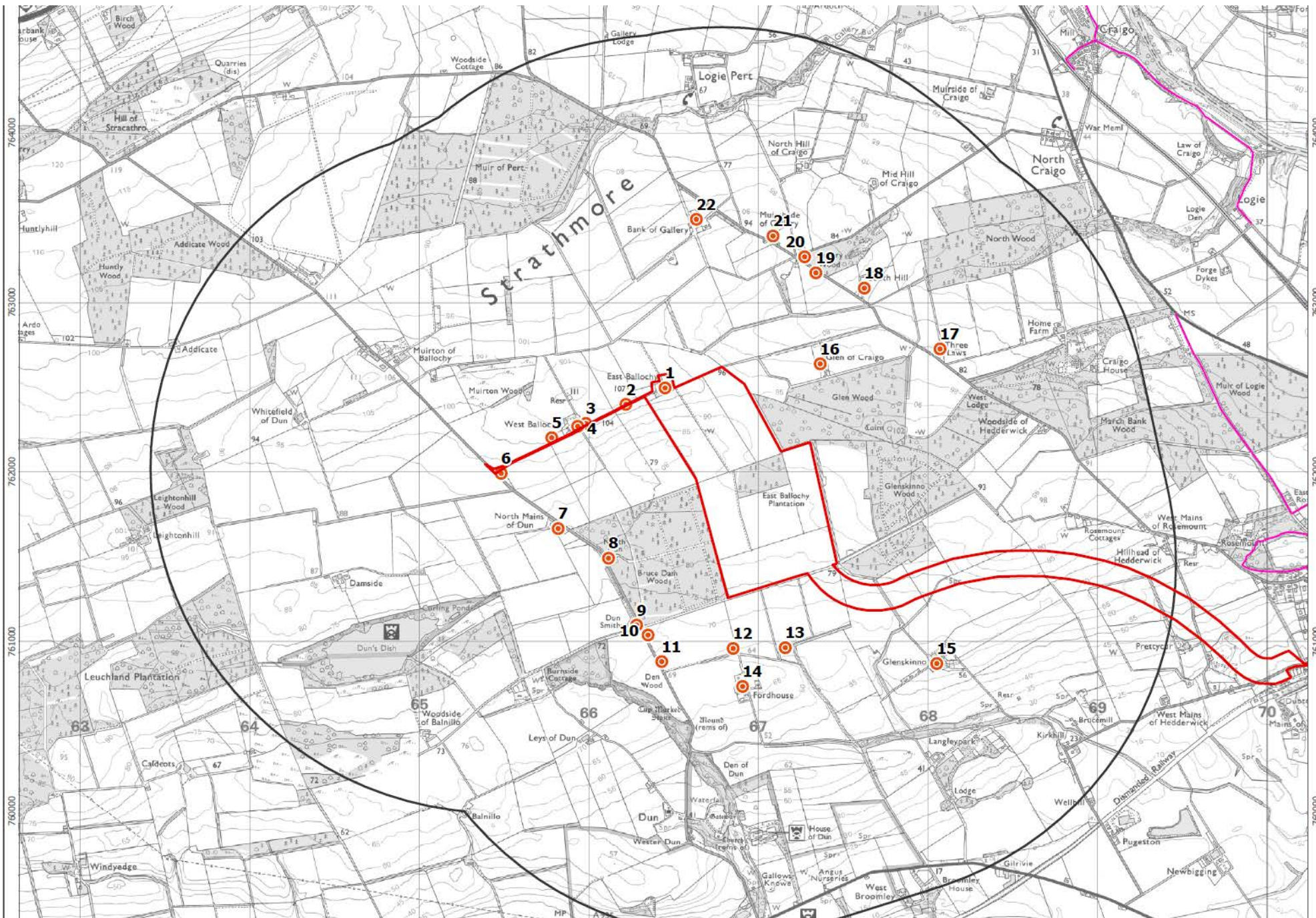

- Application Boundary
- Landscape Study Areas
- 2 km Study Area
- Core Paths

- Residential Property
  1. East Ballochly Farm
  2. East Ballochly Cottage
  3. West Ballochly Cottage
  4. West Ballochly House
  5. West Ballochly  
- 4 bungalow properties
  6. Murrion Cottage & bungalow  
- 2 properties
  7. North Mains of Dun
  8. Brucedam Cottage
  9. Woodside of Dun  
- 2 properties
  10. Woodside of Dun  
- 1 property
  11. Unnamed cottage
  12. Fordhouse Cottages  
- 2 properties
  13. Rainbows End
  14. Fordhouse
  15. Glenskinno
  16. Glenwood of Craigo  
- 2 properties
  17. Three Laws Steading
  18. South Hill of Craigo
  19. Unnamed property
  20. Quarry Tack of Gallery & unnamed property
  21. Muirshade of Gallery  
- 2 properties
  22. Bank of Gallery



Produced By: WM	Ref: 3370-REP-025
Checked By: CH	Date: 08/01/2020





Approximate Extent of Proposed Development Boundary

Existing Site Photo



Proposed Development Photomontage









Approximate Extent of Proposed Development Boundary

Existing Site Photo



Proposed Development Photomontage





Approximate Extent of Proposed Development Boundary



Approximate Extent of Proposed Development Boundary



\* VARIABLE DEPTH

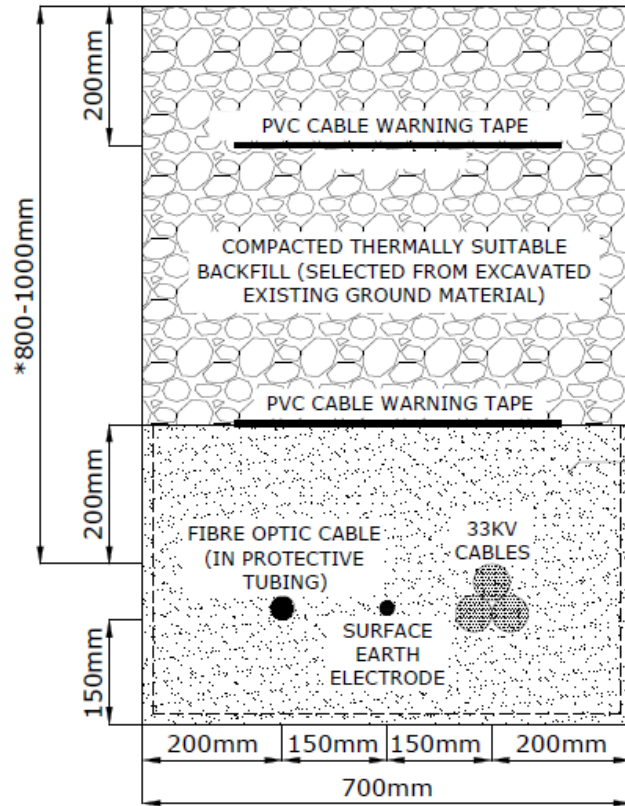

SAND BEDDING: FOR ALL OPEN TRENCHING, A GEO-SYNTHETIC SHEETING SHALL SURROUND SAND BEDDING MATERIAL, THAT SHALL BE IN ACCORDANCE WITH EA TS 97-1 SPECIAL BACKFILLING MATERIAL FOR CABLE INSTALLATIONS

TYPICAL CABLE TRENCH DETAIL

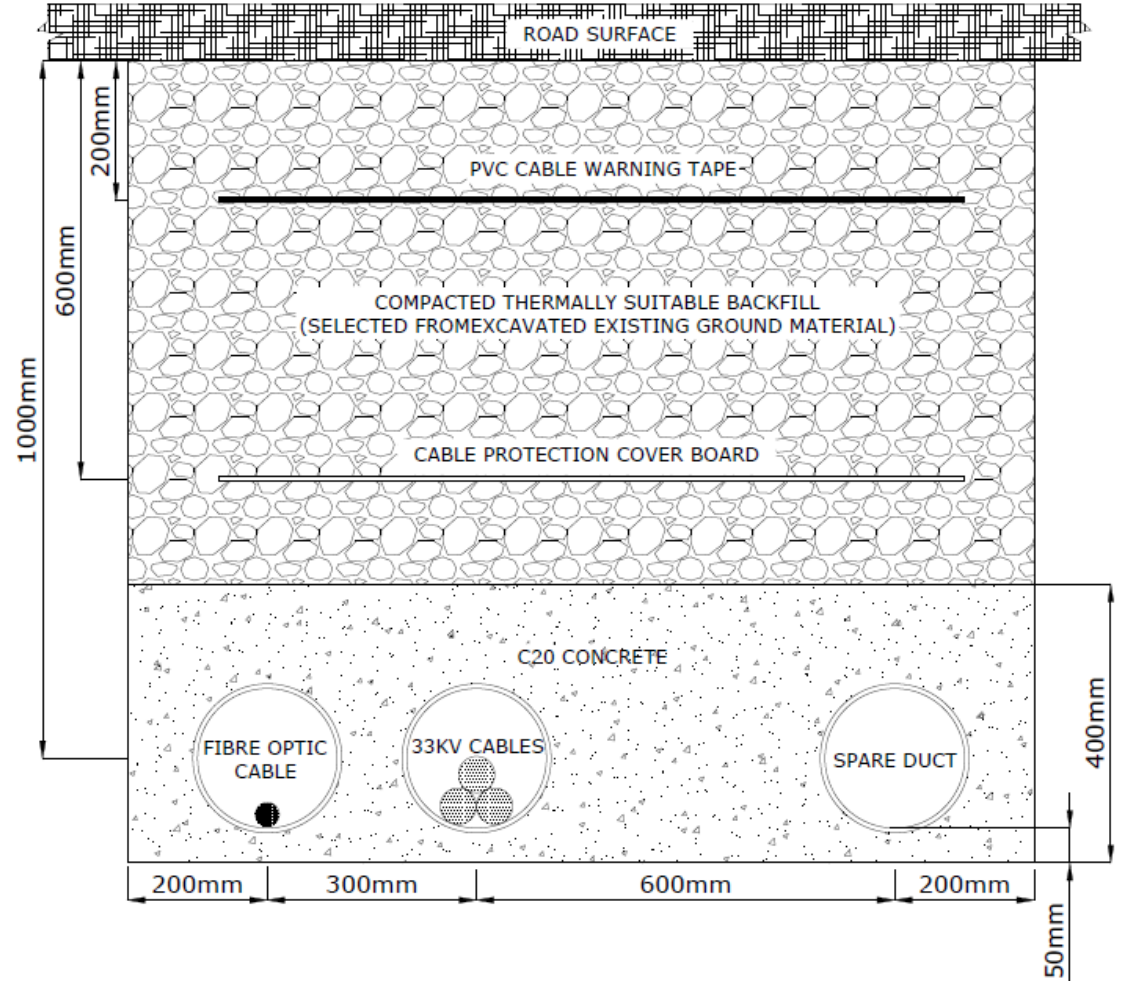

TYPICAL CABLE TRENCH DETAIL AT ROAD CROSSING



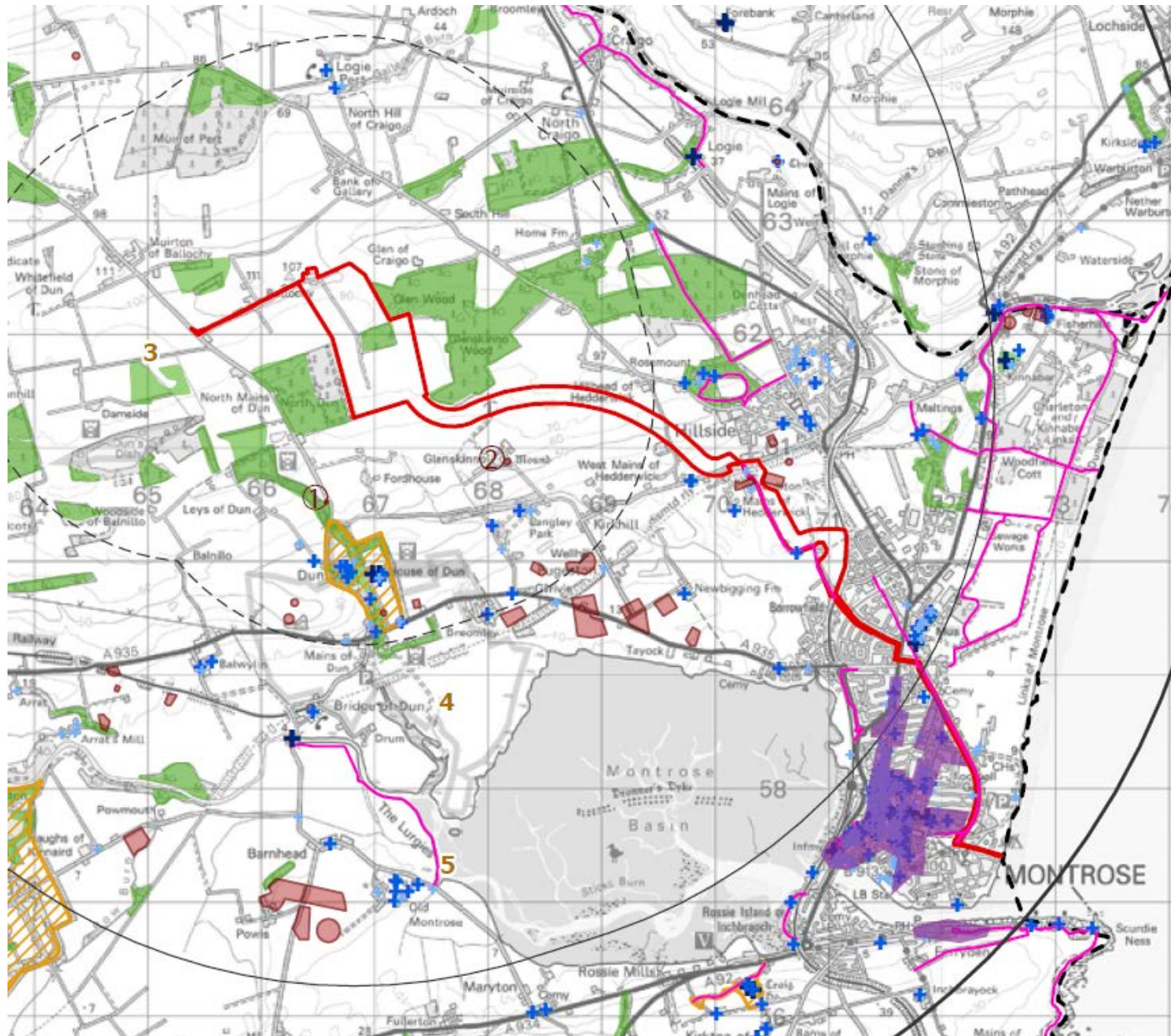



 Application Boundary

 Local Planning Authorities

Landscape Study Areas

 2 km Study Area

 5 km Study Area without Cable

 7 km Study Area

Listed Buildings

 A

 B

 C

 Core Paths

 Ancient Woodland Inventory

 Gardens and Designed Landscapes

1. Brechin Castle
2. Kinnaird Castle
3. House of Dun
4. Craig House

 Scheduled Monuments

1. Fordhouse Barrow (SM4545)
2. Glenskinno Burial Mound (SM4681)

 Conservation Areas

1. Montrose
2. Ferryden
3. Brechnin
4. Brechin St Ninian's Square



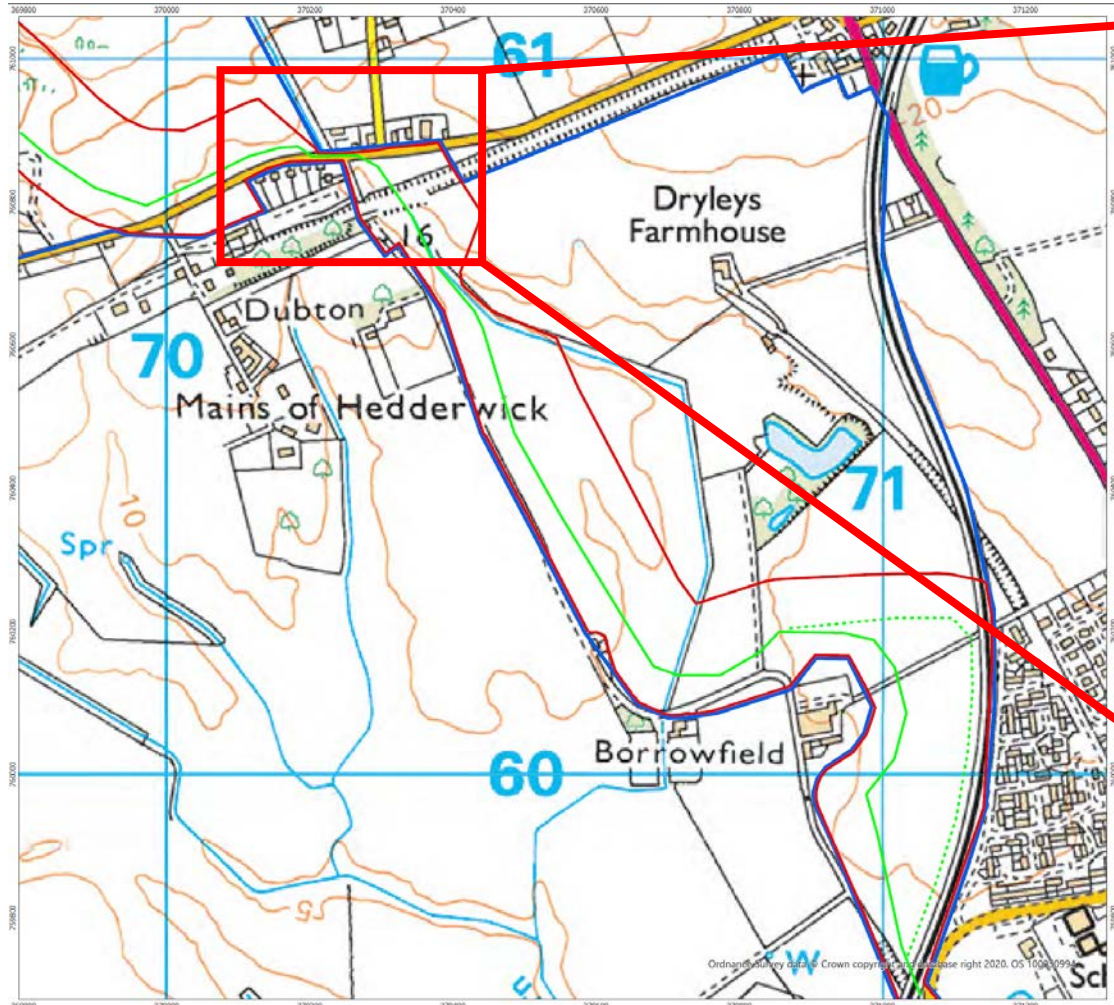



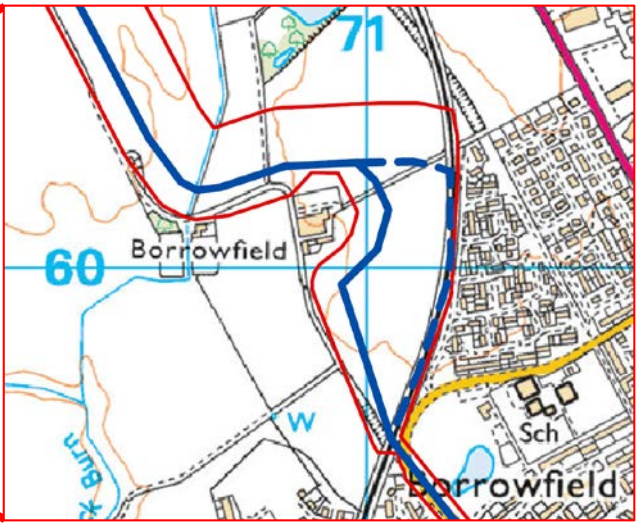
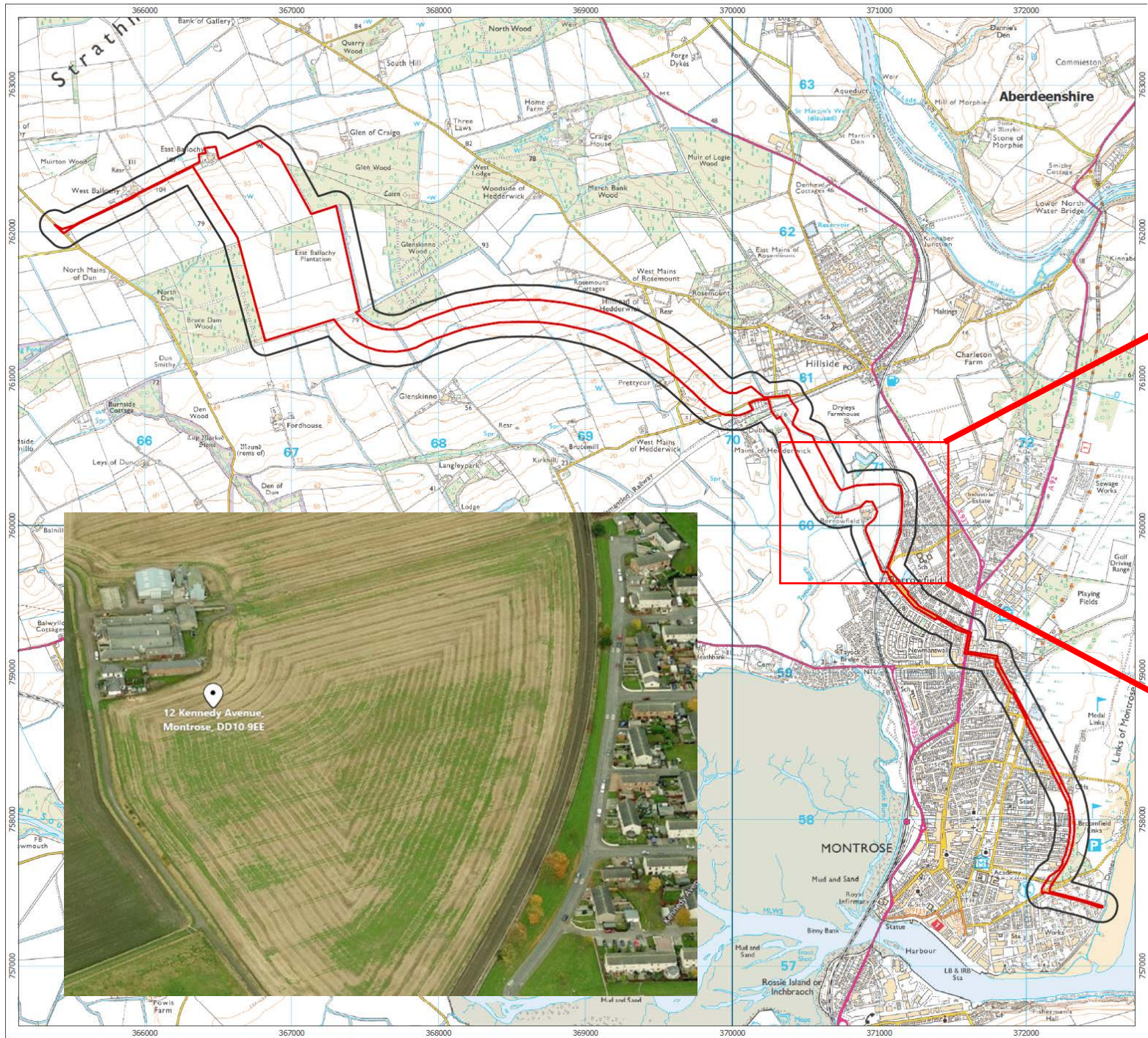



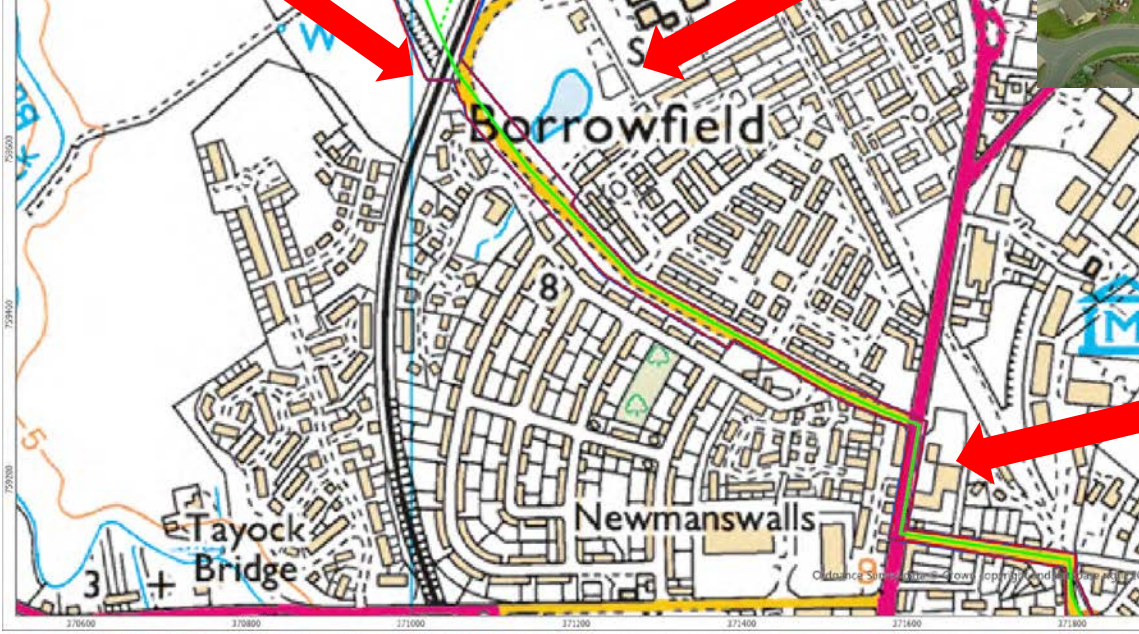
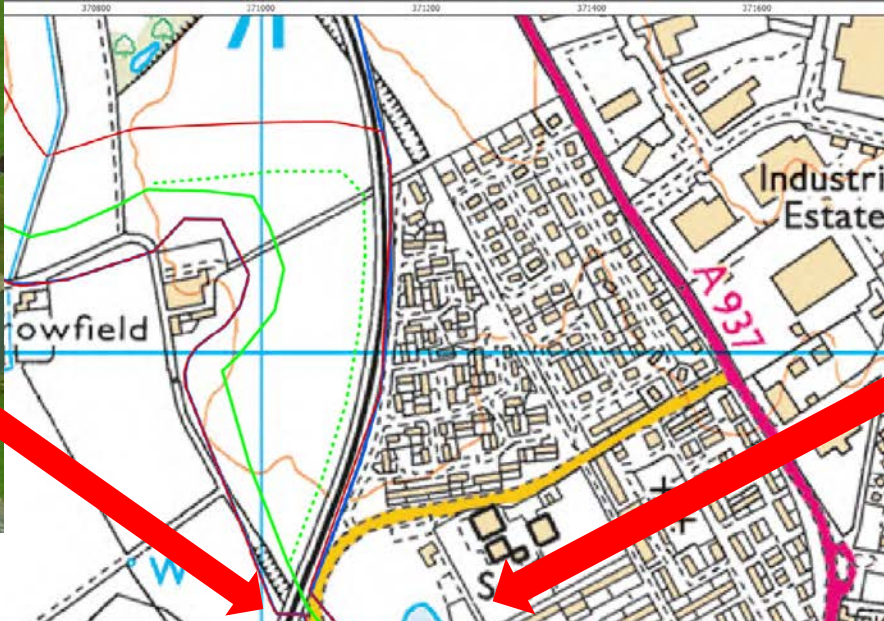
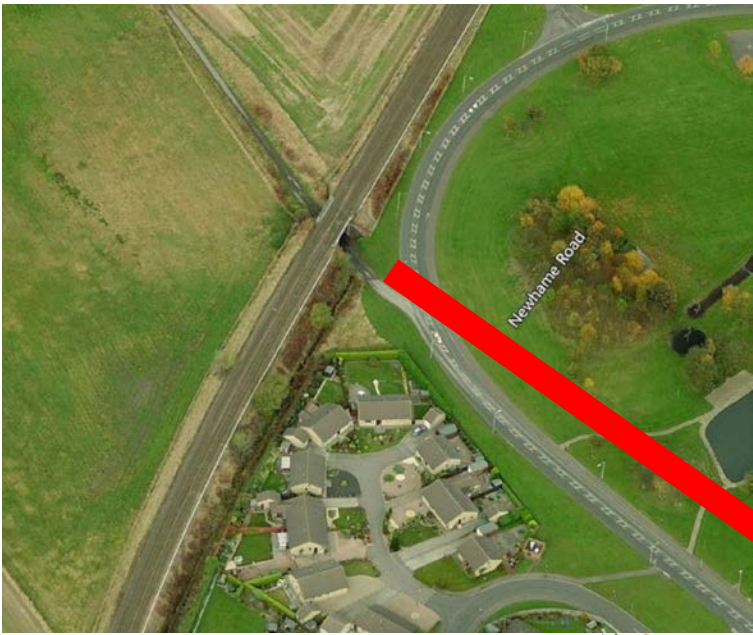







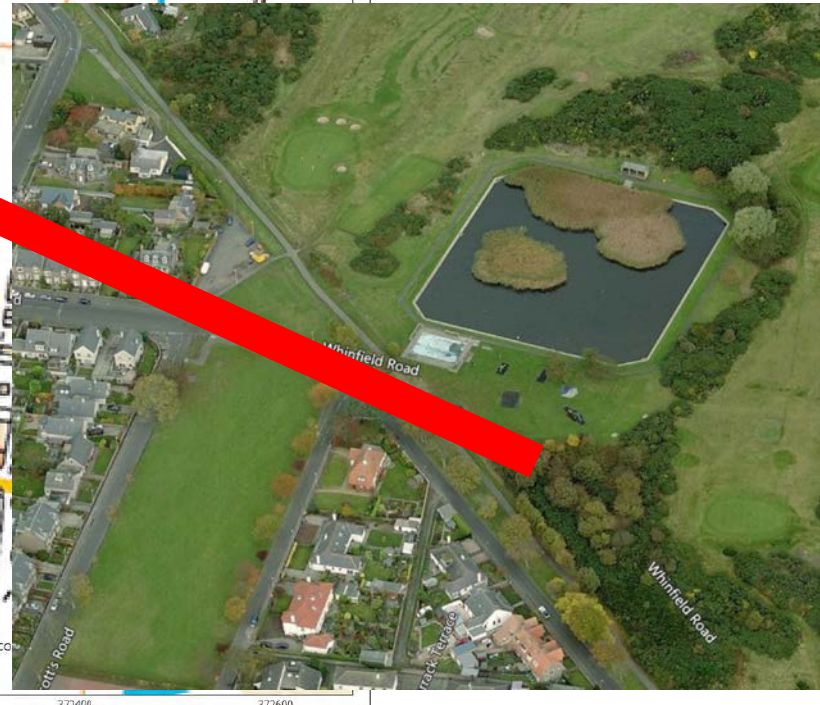







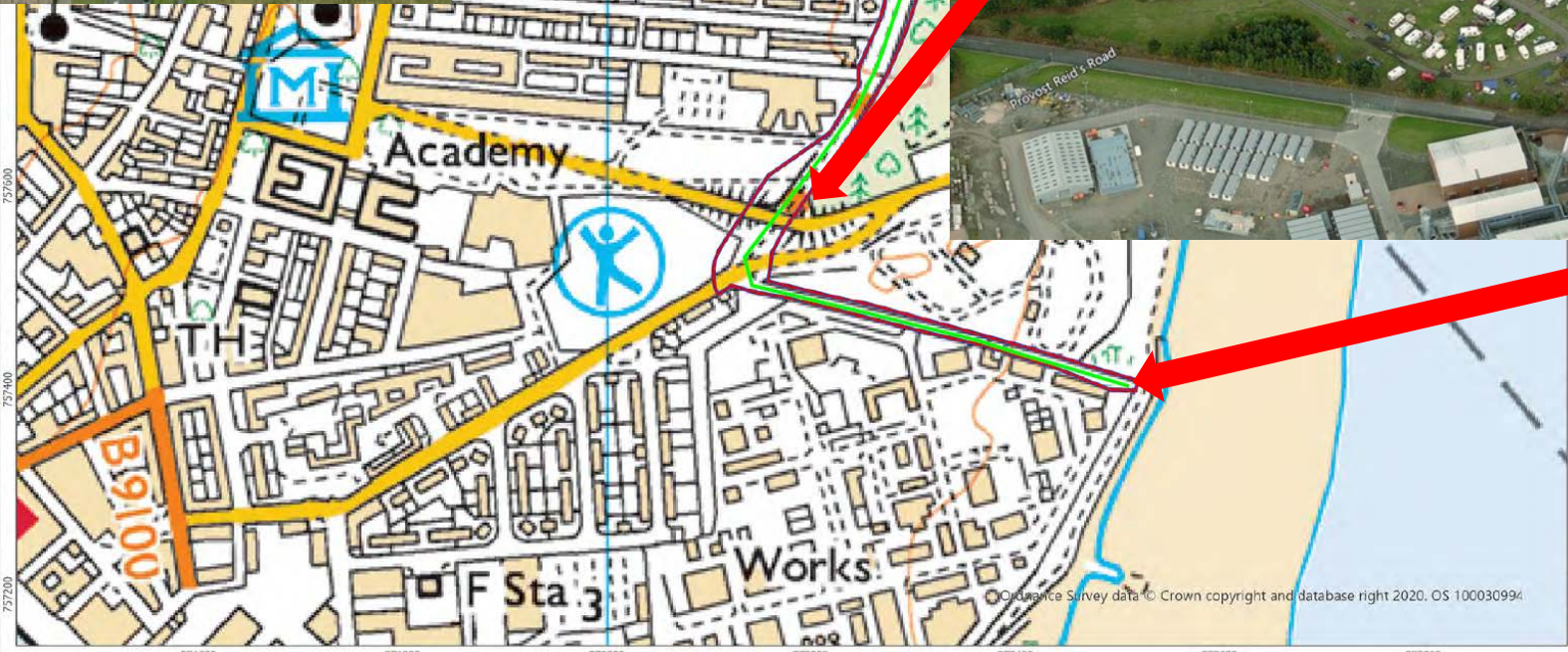
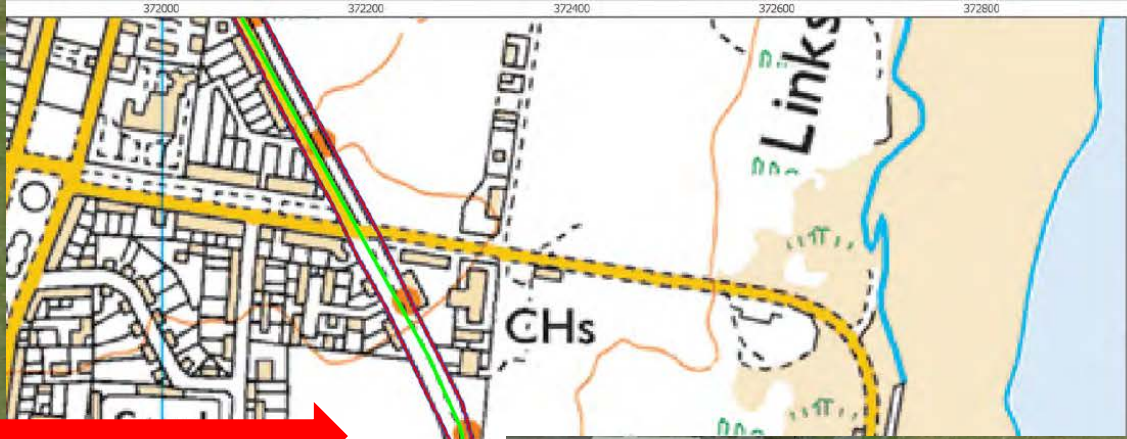

© 2020 from  
United Kingdom, Scotland,  
Angus, Montrose  
Labels





Provost Reid's Rd



# Conclusion

---

- Renewable energy development producing 12 000 home equivalent of electricity for an industrial user
- No Unacceptable impacts on amenity, environmental interests or built and natural heritage interests
- Conditions proposed to mitigate impacts
- To include precise detail and further supporting technical information with further mitigation
- Compatible with development plan policy and relative supplementary guidance
- Previous site history has similarly supported solar PV renewable development
- No material considerations that would justify refusal

