

Items 7 & 8

Planning applications: 20/00652/FULL &  
20/00829/FULL

Caravan Park, Seaton Estate, Arbroath

- 2 areas of 0.9HA
- Yellow – 36 caravan pitches
- Green – 34 caravan pitches

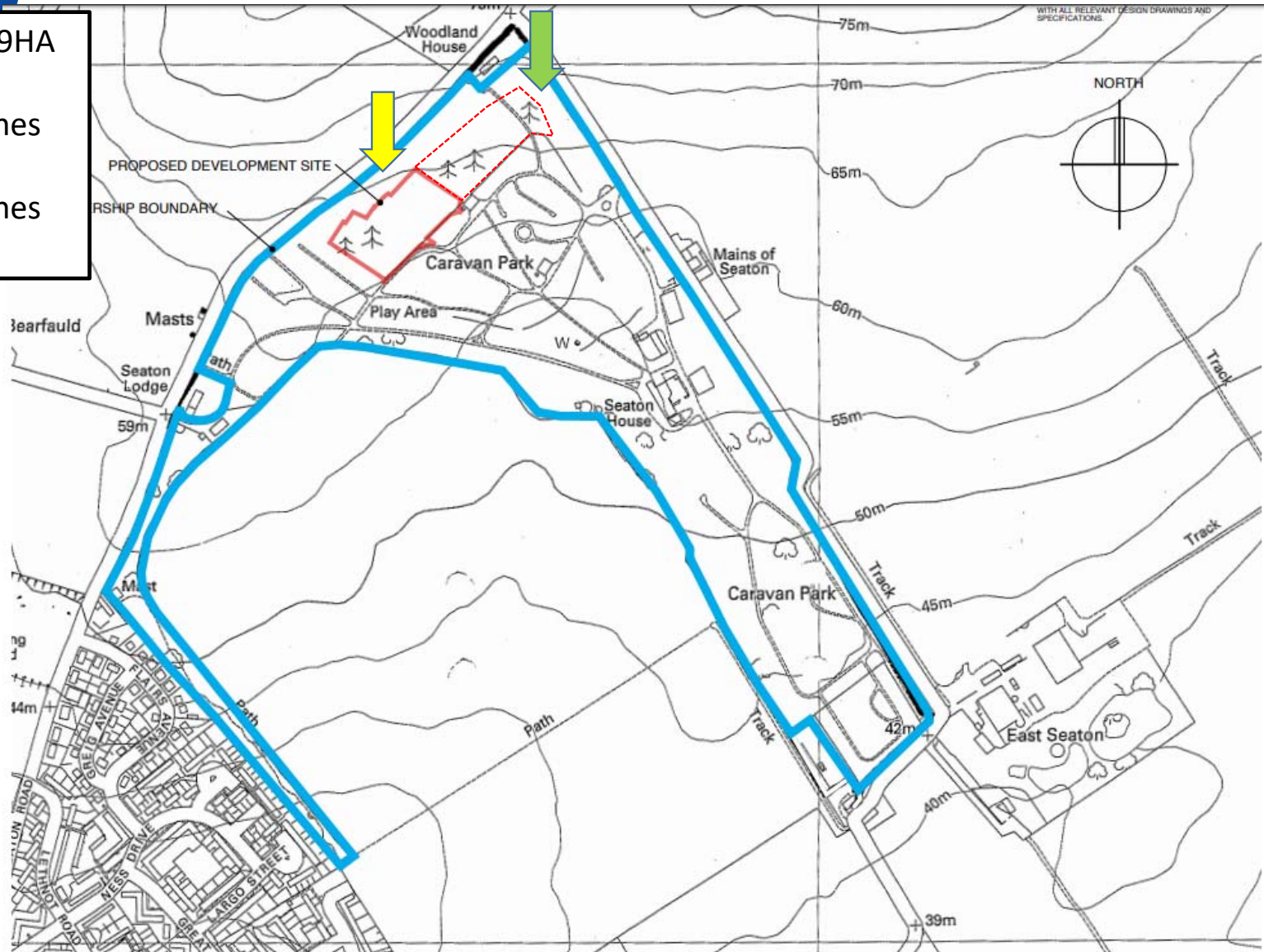





Phase 1 – 36 caravan pitches

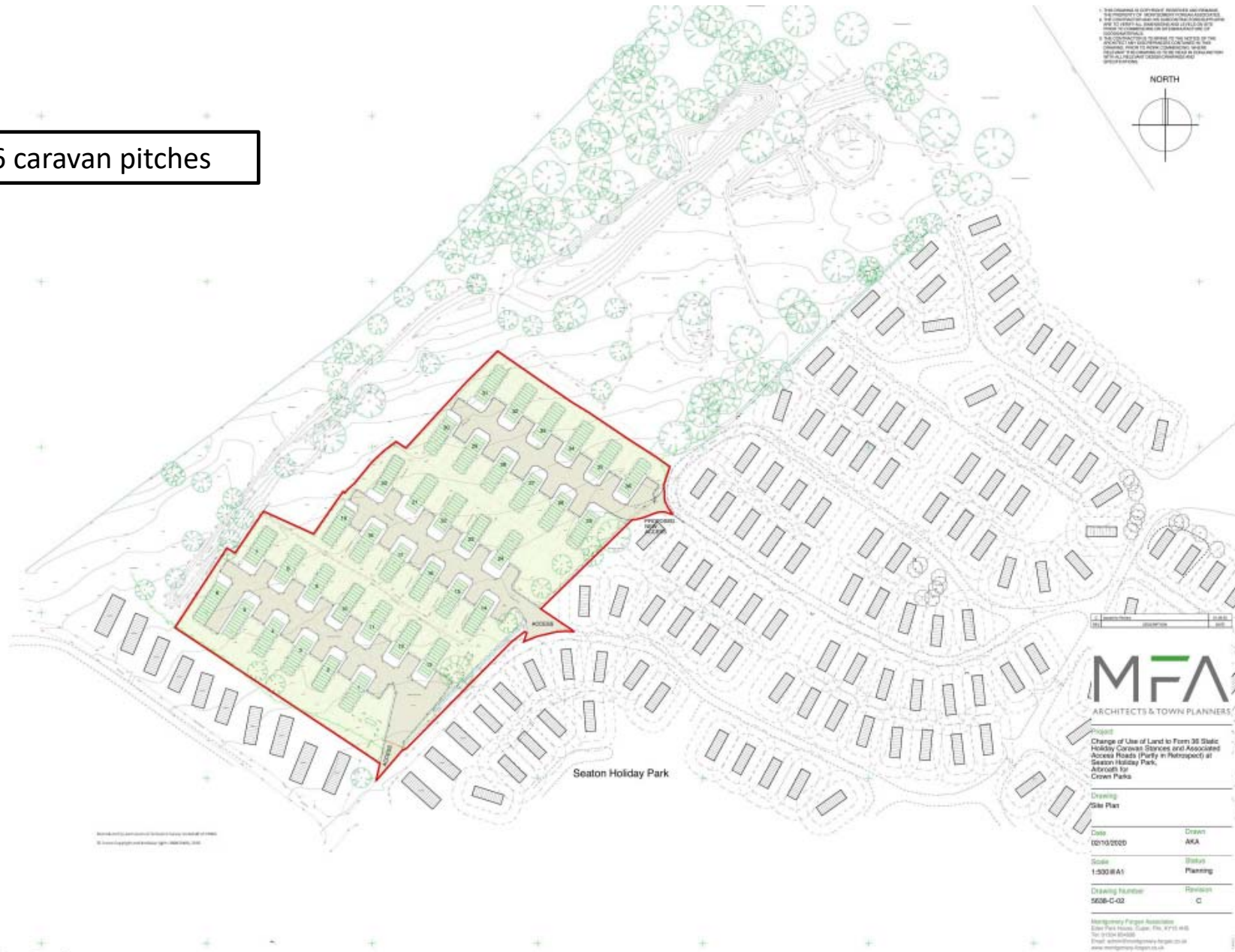

1. The information contained in this document is confidential and should not be disclosed to any third party without the prior written consent of the client.  
2. The information contained in this document is for the use of the client only and should not be used for any other purpose.  
3. The information contained in this document is for the use of the client only and should not be used for any other purpose.



**MFA**  
ARCHITECTS & TOWN PLANNERS

**Project**  
Change of Use of Land to Form 36 Static Holiday Caravan Stances and Associated Access Roads (Partly in Prospect) at Seaton Holiday Park, Alfreton for Crown Pleas

**Drawing**  
Site Plan

Date: 02/10/2020 Drawn: ANA

Scale: 1:500 (A1) Status: Planning

Drawing Number: Revision  
5608-C-02 C

Margaryta Fegan Associates  
Seaton Park Home, Seaton, Flint, WY10 4EG  
Tel: 01574 882000  
Email: info@margarytafegan.co.uk  
www.margarytafegan.co.uk







Drainage plan – foul drainage pumped to public sewer on Seaton Road

- Foul system has building warrant
- Capacity exists in WWTW
- Roads – flooding no objection subject to conditions

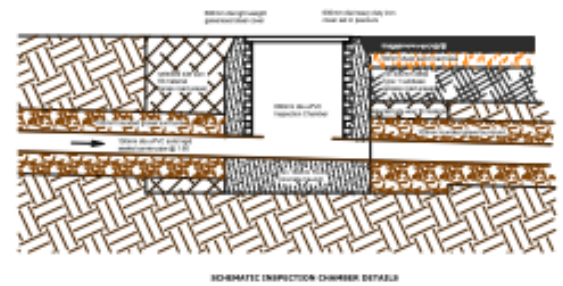
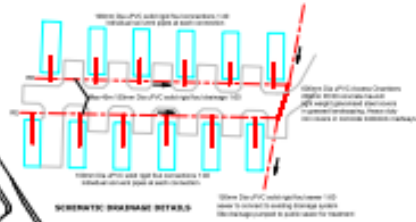
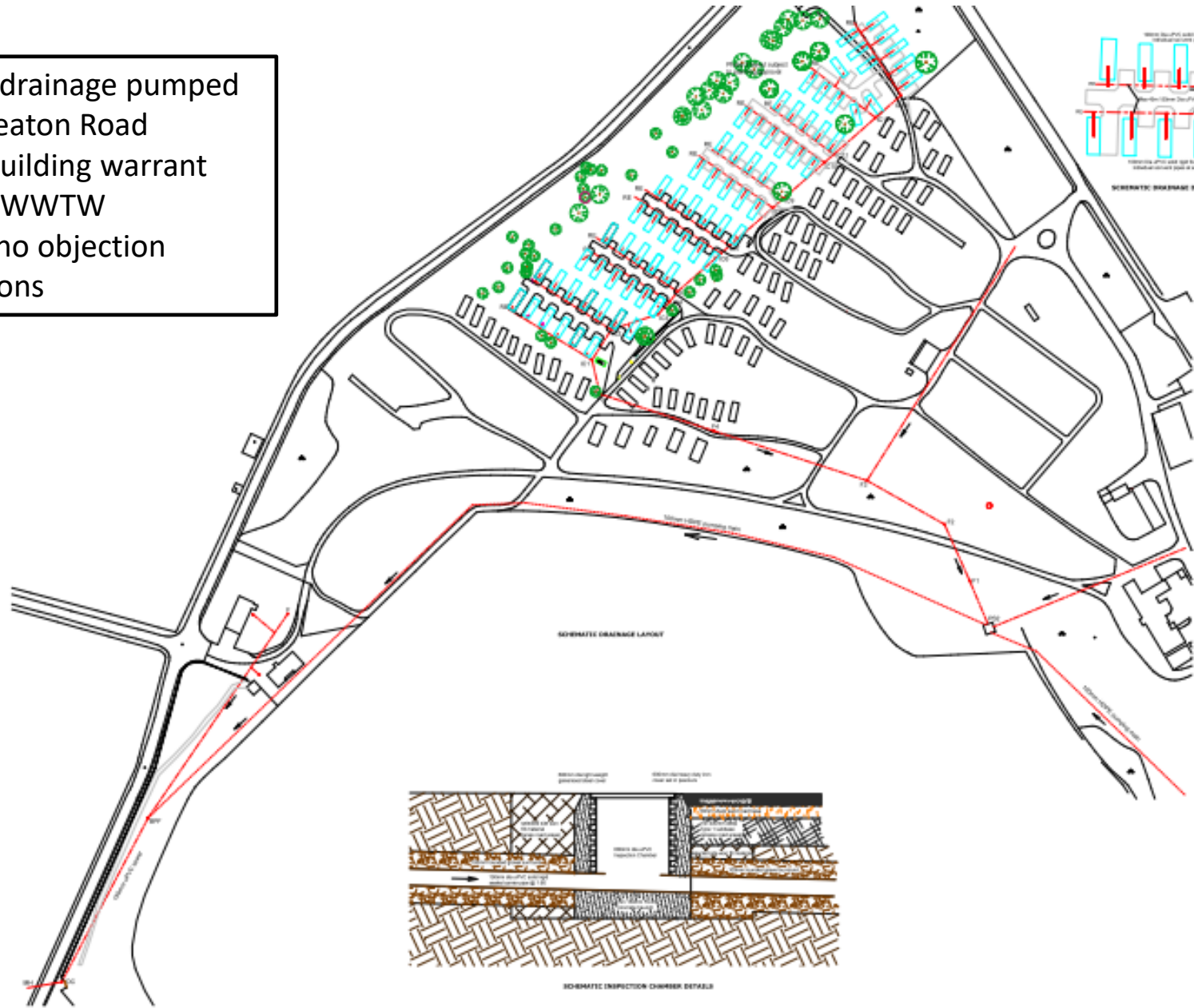

Show ground storage tank in the main drainage layout. Design in relevant and related sections for 200mm dia.

**NOTES**

1. All pipes shall be 100mm dia. PVC-U.

2. All manholes shall be 100mm dia. PVC-U.

3. All pipes shall be 150mm dia. PVC-U.

4. All manholes shall be 150mm dia. PVC-U.

5. All pipes shall be 200mm dia. PVC-U.

6. All manholes shall be 200mm dia. PVC-U.

7. All pipes shall be 300mm dia. PVC-U.

8. All manholes shall be 300mm dia. PVC-U.

9. All pipes shall be 400mm dia. PVC-U.

10. All manholes shall be 400mm dia. PVC-U.

11. All pipes shall be 500mm dia. PVC-U.

12. All manholes shall be 500mm dia. PVC-U.

13. All pipes shall be 600mm dia. PVC-U.

14. All manholes shall be 600mm dia. PVC-U.

15. All pipes shall be 800mm dia. PVC-U.

16. All manholes shall be 800mm dia. PVC-U.

17. All pipes shall be 1000mm dia. PVC-U.

18. All manholes shall be 1000mm dia. PVC-U.

19. All pipes shall be 1200mm dia. PVC-U.

20. All manholes shall be 1200mm dia. PVC-U.

Pipe Size	Length	Material	Quantity
100	100	PVC-U	1.00
150	100	PVC-U	1.00
200	100	PVC-U	1.00
300	100	PVC-U	1.00
400	100	PVC-U	1.00
500	100	PVC-U	1.00
600	100	PVC-U	1.00
800	100	PVC-U	1.00
1000	100	PVC-U	1.00
1200	100	PVC-U	1.00

Proposed 20th Floor Extension  
to Seaton Estate, Ashworth  
for Green Park Ltd

Schematic Foul Sewer Layout  
and Proposed Details

**GEMMELL HAMMOND  
& PARTNERS**

Chartered Civil Engineers, Surveyors,  
and Quantity Surveyors

100th Floor, Seaton  
Estate, Ashworth, S62 0JY  
Tel: 01454 622222

DATE: 01/10/2020

REF: 2020-01-1















**ITEM 7** – 59 reps (12 objections, 44 letters of support, 3 neither in support or obj.)

**ITEM 8** – No representations

ALDP supports tourism accommodation in appropriate locations

- Drainage solution acceptable
- Impacts on trees – woodland restoration required
- Impacts similar to extant permission – reduction in caravans (89 to 70)
- Planning conditions to mitigate impacts
- Operation of site controlled through caravan site licence

