

Items 7 and 8

Applications: 20/00825/MSC & 20/00826/FULL

Section 42 applications

Land at Carlogie, Carnoustie

Carnoustie & Barry (Inset Map 3)

This Proposals Map should be read in conjunction with the Written Statement

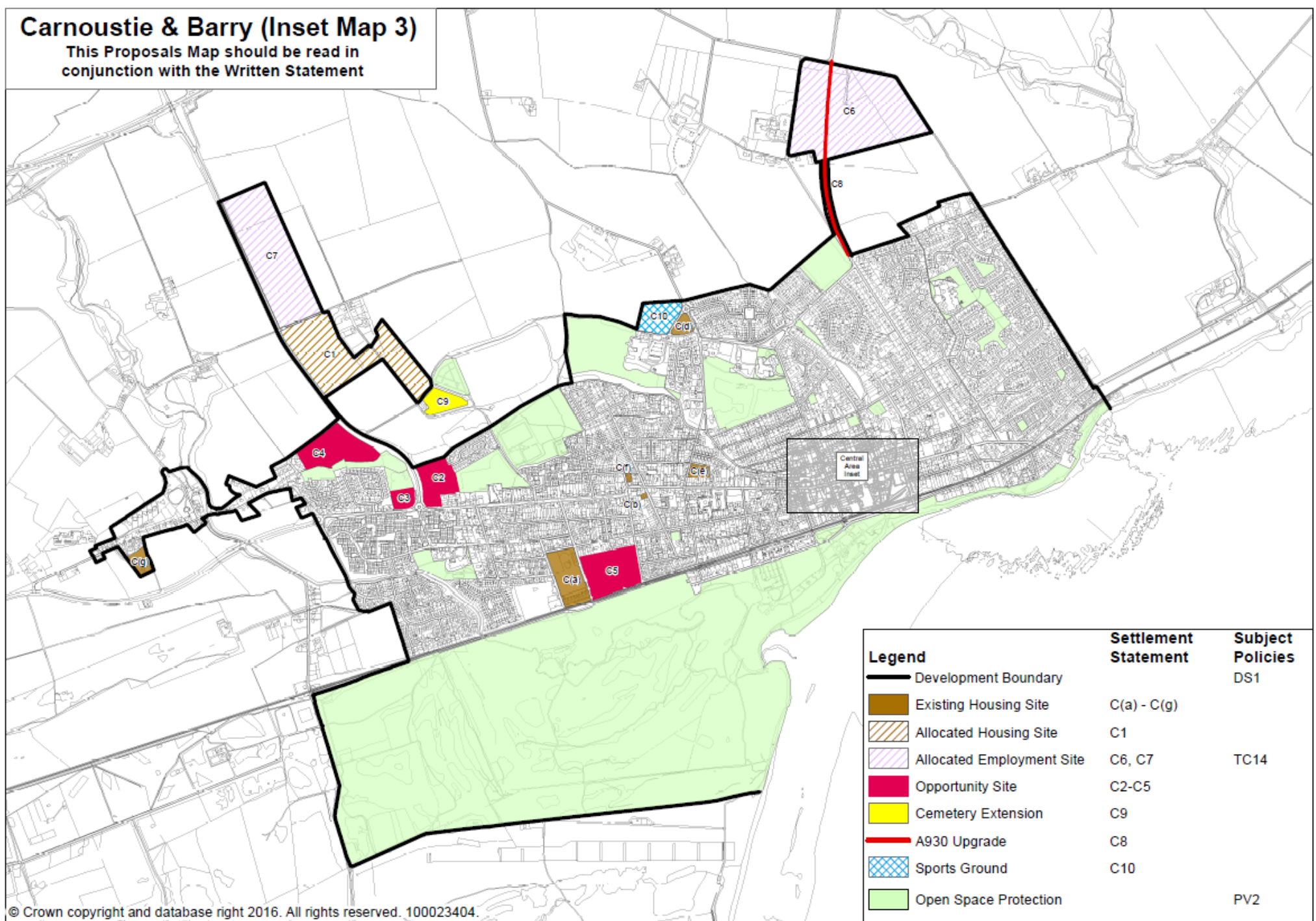

Legend	Settlement Statement	Subject Policies
Development Boundary		DS1
Existing Housing Site	C(a) - C(g)	
Allocated Housing Site	C1	
Allocated Employment Site	C6, C7	TC14
Opportunity Site	C2-C5	
Cemetery Extension	C9	
A930 Upgrade	C8	
Sports Ground	C10	
Open Space Protection		PV2



Reproduced by permission of the Texas Surveyors Association on behalf of the State of Texas.
 © 2016 Copyright and database rights 2016/2017, 2018.

Revision	Description	By	Check By	Date
R1.1	Grading number amended from ASL_02_XX_DR_A_0100 to ASL_02_XX_DR_A_0001	ms		21.07.17
R2.1	Blue line site boundary added for clarification	ms		02.08.17
R2.2	Blue line site boundary alterations	ms		02.08.17
R2.3	Blue line site boundary amended following clarification on Council comment	ms		02.08.17

Revision	Description	By	Check By	Date

© 2017 ASL. All rights reserved. No part of this document may be reproduced or transmitted in any form or by any means, electronic or mechanical, including photocopying, recording, or by any information storage and retrieval system, without permission in writing from Austin-Smith:Lord. This document is the property of Austin-Smith:Lord and is to be used only for the project and site identified herein. It is not to be distributed to any other party without the written consent of Austin-Smith:Lord.

Drawn: ms
 Date: April 2017
 Scale: 1:2000 @ A1
 Status: S3

Austin-Smith:Lord LLP
 Architects, Engineers, Planners
 Landscape Architects
 206 St Vincent Street
 Glasgow G2 3JG
 T 0141 223 8900
 F 0141 223 8905
 e gls@asm-london.com

Austin-Smith:Lord
 Project: Cottage Business Park
 Location: Manchester
 Description: Site Plan
 Proposed Development: Boustons
 Job No: 2217026
 Drawing No: ASL_10_XX_DR_A_0001
 Revision: PLS

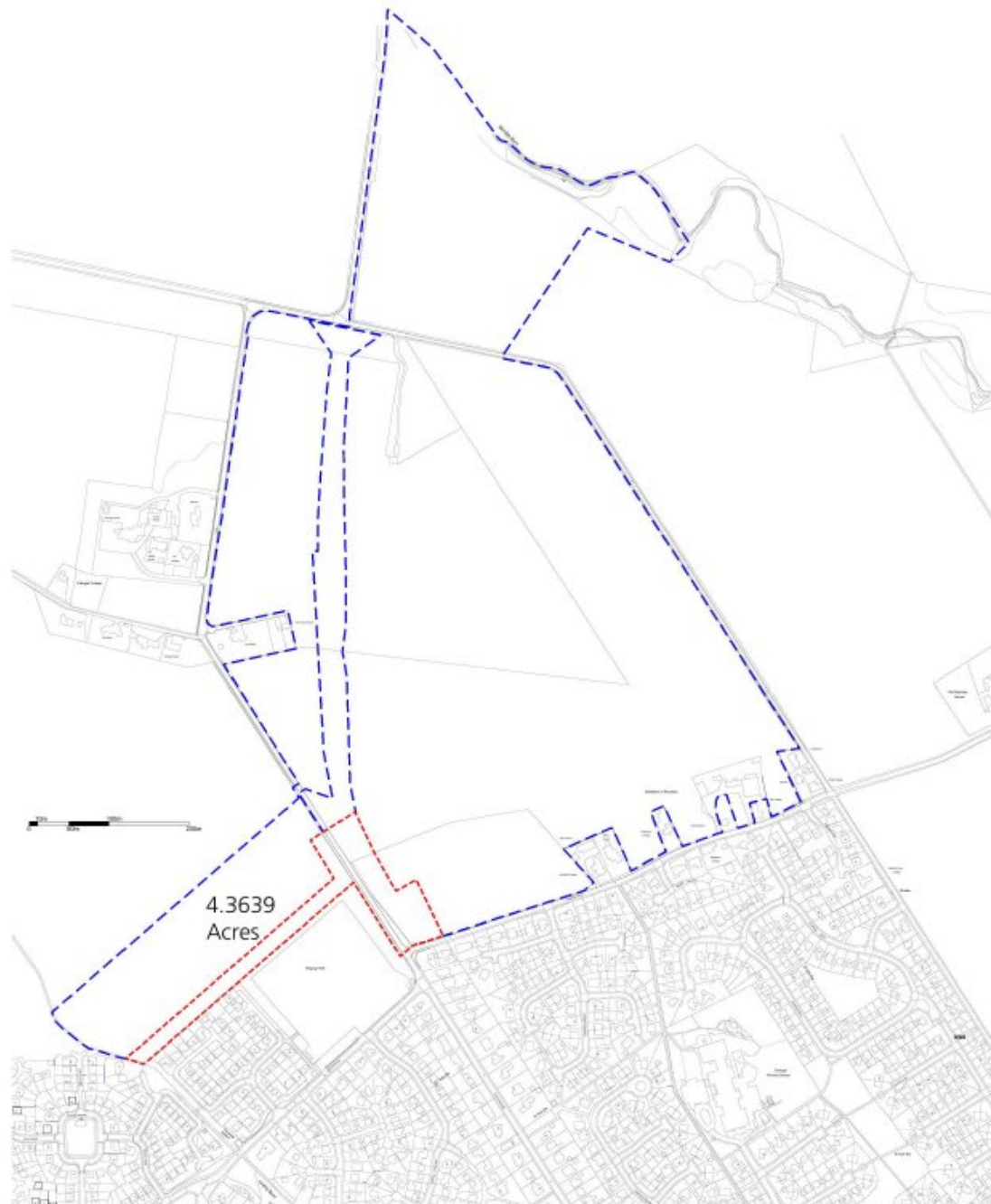

Reproduced by permission of the survey surveyor or land of 4000.
 © 2017 Copyright and database rights 10000000, 2017.

NO.	DATE BY	DESCRIPTION	NO.	DATE BY	DESCRIPTION

NO.	DATE BY	DESCRIPTION	NO.	DATE BY	DESCRIPTION

Austin-Smith:Lord
 Project: Garages Addition Park
 Description: Middle Boundary Site Plan
 Job No.: 212026
 Drawing No.: ASL_00_XX_DR_A_1001
 Date: August 2017
 Scale: 1:3000 @ A1
 Status: ST
 Austin-Smith:Lord LLP
 6000 West Loop South
 Suite 1000
 Dallas, TX 75206
 Phone: (214) 223-9500
 Fax: (214) 223-9501
 Email: a.sl@asl.com



Northern facing view

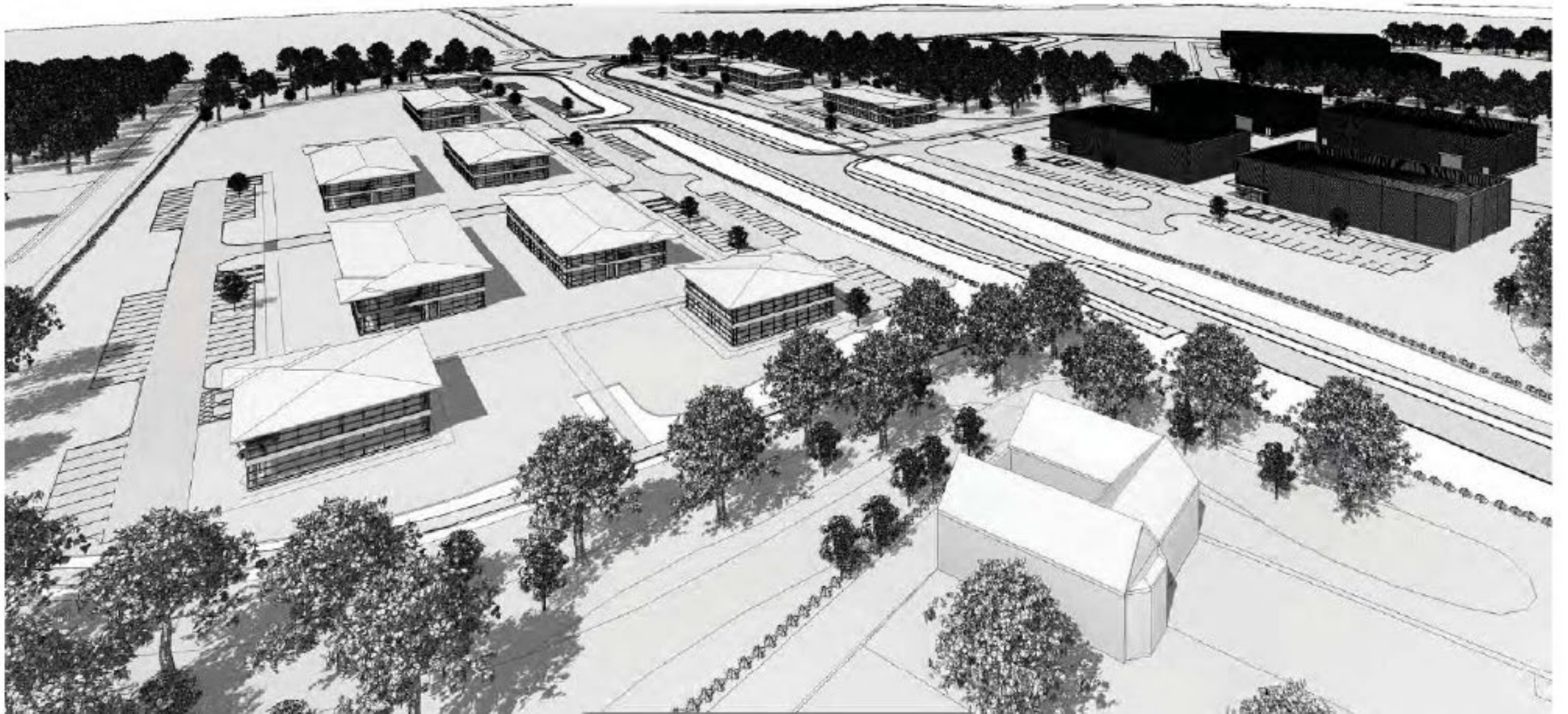

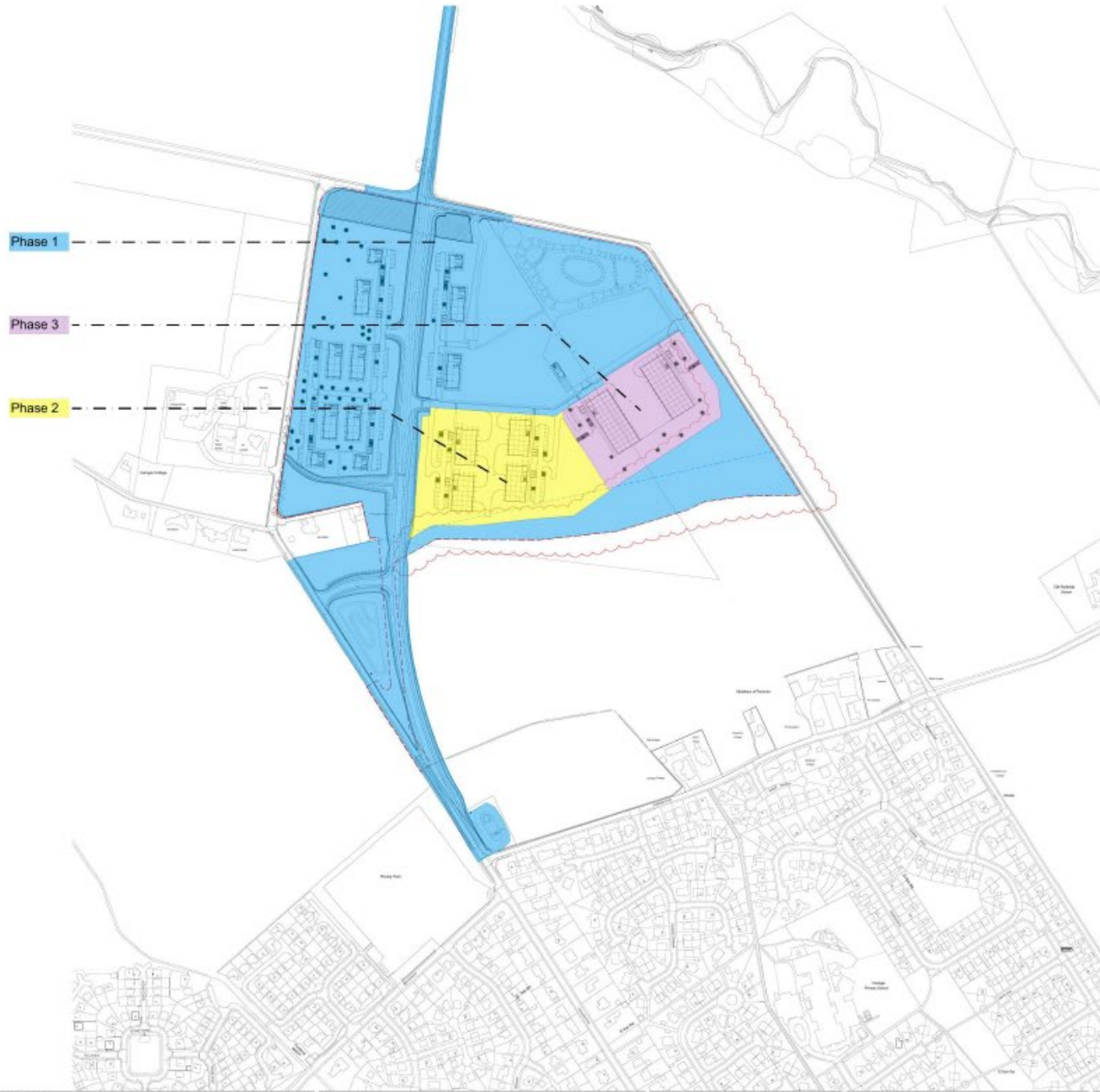

Revised by permission of Dr. ... as of 1/1/11.
 © 2011 Dr. ... All rights reserved.

Revised	Description	By	DATE	DATE	REVISION DESCRIPTION	NO.	DATE BY DATE	REVISION DESCRIPTION	BY	DATE	DATE	REVISION DESCRIPTION	NO.	DATE BY DATE	REVISION DESCRIPTION	BY	DATE	DATE	REVISION DESCRIPTION
1.0	Site plan showing building footprints, parking, and site boundaries. Includes a north arrow and scale bar.	ASL	01/11/11	01/11/11	Initial site plan.														
2.0	Revised site plan showing building footprints, parking, and site boundaries. Includes a north arrow and scale bar.	ASL	02/01/11	02/01/11	Revised building footprints and parking areas.														
3.0	Revised site plan showing building footprints, parking, and site boundaries. Includes a north arrow and scale bar.	ASL	02/01/11	02/01/11	Final site plan.														

Austin-Smith+Lord
 Architects, Engineers, Planners
 and Interiors
 200 West Street
 Austin, Texas 78701
 Phone: 512.476.1111
 Fax: 512.476.1112
 www.asl.com

Project: ...
 Date: ...
 Scale: 1/8" = 1'-0"
 Status: ...



Approved by permission of District Council on behalf of H&M
 © Crown Copyright and Database Rights 2002/2008, 2002

NO	DESCRIPTION	BY	DATE	DATE	NO	DESCRIPTION	BY	DATE	DATE
PT	Planning Development Following Client Revision	ML	July '20	06/09/20					
PT1	Planning Development Following Revision with The Council	ML	November '20						

NO	DESCRIPTION	BY	DATE	DATE
01	Issue for Client Review	ML	July '20	06/09/20
02	Issue for Client Review	ML	July '20	06/09/20
03	Issue for Client Review	ML	July '20	06/09/20
04	Issue for Client Review	ML	July '20	06/09/20
05	Issue for Client Review	ML	July '20	06/09/20
06	Issue for Client Review	ML	July '20	06/09/20
07	Issue for Client Review	ML	July '20	06/09/20
08	Issue for Client Review	ML	July '20	06/09/20
09	Issue for Client Review	ML	July '20	06/09/20
10	Issue for Client Review	ML	July '20	06/09/20

Austin-Smith:Lord
 Landscape Architects

21 Ruffell Street
 Glasgow G2 4LR
 T 0141 221 8900
 F 0141 221 9001
 e a.s.l@asm-l.com

Project: **Eastgate Business Park**

Description: **Masterplan**

Drawing No: **2117026** Revision: **01**

Date: **June 2023**

Scale: **1:2500 @ A1**

Status: **S2**



WOODLAND MIX A

% OF MIX	Species	Common name	Size at planting	Density
10	Pagea dyvaria	Beach	100-150cm tall, 20 transplanted, bare root	1 per 200'
10	Daphne genkwa	Beetle oak	120-150cm tall, 20 transplanted, bare root	1 per 200'
10	Prunus laurocerasus	Laurel	120-150cm tall, 20 transplanted, bare root	1 per 200'
10	Prunus laurocerasus	Laurel	120-150cm tall, 20 transplanted, bare root	1 per 200'
10	Prunus laurocerasus	Laurel	120-150cm tall, 20 transplanted, bare root	1 per 200'
10	Prunus laurocerasus	Laurel	120-150cm tall, 20 transplanted, bare root	1 per 200'
10	Prunus laurocerasus	Laurel	120-150cm tall, 20 transplanted, bare root	1 per 200'
10	Prunus laurocerasus	Laurel	120-150cm tall, 20 transplanted, bare root	1 per 200'
10	Prunus laurocerasus	Laurel	120-150cm tall, 20 transplanted, bare root	1 per 200'
10	Prunus laurocerasus	Laurel	120-150cm tall, 20 transplanted, bare root	1 per 200'

WOODLAND MIX B

% OF MIX	Species	Common name	Size at planting	Density
10	Pagea dyvaria	Beach	100-150cm tall, 20 transplanted, bare root	1 per 200'
10	Daphne genkwa	Beetle oak	120-150cm tall, 20 transplanted, bare root	1 per 200'
10	Prunus laurocerasus	Laurel	120-150cm tall, 20 transplanted, bare root	1 per 200'
10	Prunus laurocerasus	Laurel	120-150cm tall, 20 transplanted, bare root	1 per 200'
10	Prunus laurocerasus	Laurel	120-150cm tall, 20 transplanted, bare root	1 per 200'
10	Prunus laurocerasus	Laurel	120-150cm tall, 20 transplanted, bare root	1 per 200'
10	Prunus laurocerasus	Laurel	120-150cm tall, 20 transplanted, bare root	1 per 200'
10	Prunus laurocerasus	Laurel	120-150cm tall, 20 transplanted, bare root	1 per 200'
10	Prunus laurocerasus	Laurel	120-150cm tall, 20 transplanted, bare root	1 per 200'
10	Prunus laurocerasus	Laurel	120-150cm tall, 20 transplanted, bare root	1 per 200'

WOODLAND MIX C

% OF MIX	Species	Common name	Size at planting	Density
10	Pagea dyvaria	Beach	100-150cm tall, 20 transplanted, bare root	1 per 200'
10	Daphne genkwa	Beetle oak	120-150cm tall, 20 transplanted, bare root	1 per 200'
10	Prunus laurocerasus	Laurel	120-150cm tall, 20 transplanted, bare root	1 per 200'
10	Prunus laurocerasus	Laurel	120-150cm tall, 20 transplanted, bare root	1 per 200'
10	Prunus laurocerasus	Laurel	120-150cm tall, 20 transplanted, bare root	1 per 200'
10	Prunus laurocerasus	Laurel	120-150cm tall, 20 transplanted, bare root	1 per 200'
10	Prunus laurocerasus	Laurel	120-150cm tall, 20 transplanted, bare root	1 per 200'
10	Prunus laurocerasus	Laurel	120-150cm tall, 20 transplanted, bare root	1 per 200'
10	Prunus laurocerasus	Laurel	120-150cm tall, 20 transplanted, bare root	1 per 200'
10	Prunus laurocerasus	Laurel	120-150cm tall, 20 transplanted, bare root	1 per 200'

HEDGEROWS

% OF MIX	Species	Common name	Height	Spacings
10%	Crataegus monogyna	Hawthorn	80-100cm	1.0m x 1.0m
10%	Crataegus monogyna	Hawthorn	80-100cm	1.0m x 1.0m
10%	Crataegus monogyna	Hawthorn	80-100cm	1.0m x 1.0m

GRASS SEEDING + MEADOW MIX

Code	Species	Quantity
GA	Mix of 100kg seed and 100kg fertilizer	100kg
GV	Mix of 100kg seed and 100kg fertilizer	100kg

INDIVIDUAL TREES

Ref	Species	Common Name	Height	Spacings	Plant / Row
T1	Pagea dyvaria	Beach	100-150cm	1.0m x 1.0m	100-150cm
T2	Prunus laurocerasus	Laurel	120-150cm	1.0m x 1.0m	120-150cm
T3	Prunus laurocerasus	Laurel	120-150cm	1.0m x 1.0m	120-150cm
T4	Prunus laurocerasus	Laurel	120-150cm	1.0m x 1.0m	120-150cm

SHRUB PLANTING

Ref	Species	Common Name	Density	Height	Spacings	Plant / Row
SH	Prunus laurocerasus	Laurel	1 per 200'	120-150cm	1.0m x 1.0m	120-150cm
SH	Prunus laurocerasus	Laurel	1 per 200'	120-150cm	1.0m x 1.0m	120-150cm

This site should be planted with shrubs and trees in the quantities specified in the schedule and approved. Planting should be of high standard as for the residential and commercial areas. It will be subject to the approval of the Council and the Council will be responsible for the maintenance of the planting. The Council will be responsible for the maintenance of the planting. The Council will be responsible for the maintenance of the planting.

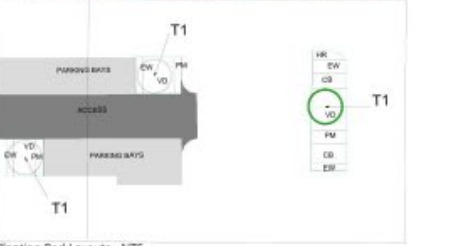

Planting Bed Layouts - NTS

Rev	Description	By	Check By	Date	Rev	Description	By	Check By	Date
01	Initial design	AS	AS	10/10/2023					
02	Revised design	AS	AS	10/10/2023					

Author	Client	Project	Location
Austin-Smith+Lord	City of Austin	City of Austin	Austin, Texas



WOODLAND MIX A

S. QP No.	Species	Common Name	Rate of planting	Density
10	Prunus serotina	Blackthorn	Planted 2 x 200 cm, branched, 16-18 weeks - staggered	1 per 200'
10	Quercus robur	Burdock oak	120-150cm tall, 3x transplanted, bare root	1 per 200'
10	Prunus Avium	Black cherry	120-150cm tall, 3x transplanted, bare root	1 per 200'
10	Prunus spinosa	Blackthorn	120-150cm tall, 3x transplanted, bare root	1 per 200'
10	Sorbus aucuparia	Rosier	120-150cm tall, 3x transplanted, bare root	1 per 200'
10	Prunus spinosa	Blackthorn	120-150cm tall, 3x transplanted, bare root	1 per 200'
10	Lonicera periclymenum	Hebe	120-150cm tall, 3x transplanted, bare root	1 per 200'
10	Lonicera periclymenum	Hebe	120-150cm tall, 3x transplanted, bare root	1 per 200'
10	Prunus serotina	Blackthorn	120-150cm tall, 3x transplanted, bare root	1 per 200'

Plant all plants within the tree compatibility boundary. However, do not plant 10-15% of the same species together in any one group. Ensure that there is a good mix of sizes as well as species. Do not exceed 15 of the same size together.

WOODLAND MIX B

S. QP No.	Species	Common Name	Rate of planting	Density
10	Betula pubescens	Downy birch	Planted 2 x 200 cm, branched, 16-18 weeks - staggered	1 per 200'
10	Betula pubescens	Downy birch	120-150cm tall, 3x transplanted, bare root	1 per 200'
10	Prunus Avium	Black cherry	120-150cm tall, 3x transplanted, bare root	1 per 200'
10	Prunus spinosa	Blackthorn	120-150cm tall, 3x transplanted, bare root	1 per 200'
10	Sorbus aucuparia	Rosier	120-150cm tall, 3x transplanted, bare root	1 per 200'
10	Quercus robur	Burdock oak	120-150cm tall, 3x transplanted, bare root	1 per 200'
10	Prunus spinosa	Blackthorn	120-150cm tall, 3x transplanted, bare root	1 per 200'
10	Prunus spinosa	Blackthorn	120-150cm tall, 3x transplanted, bare root	1 per 200'
10	Prunus spinosa	Blackthorn	120-150cm tall, 3x transplanted, bare root	1 per 200'

Plant all plants within the tree compatibility boundary. However, do not plant 10-15% of the same species together in any one group. Ensure that there is a good mix of sizes as well as species. Do not exceed 15 of the same size together.

WOODLAND MIX C

S. QP No.	Species	Common Name	Rate of planting	Density
10	Prunus Avium	Black cherry	120-150cm tall, 3x transplanted, bare root	1 per 200'
10	Prunus spinosa	Blackthorn	120-150cm tall, 3x transplanted, bare root	1 per 200'
10	Prunus spinosa	Blackthorn	120-150cm tall, 3x transplanted, bare root	1 per 200'
10	Prunus spinosa	Blackthorn	120-150cm tall, 3x transplanted, bare root	1 per 200'
10	Prunus spinosa	Blackthorn	120-150cm tall, 3x transplanted, bare root	1 per 200'
10	Prunus spinosa	Blackthorn	120-150cm tall, 3x transplanted, bare root	1 per 200'
10	Prunus spinosa	Blackthorn	120-150cm tall, 3x transplanted, bare root	1 per 200'
10	Prunus spinosa	Blackthorn	120-150cm tall, 3x transplanted, bare root	1 per 200'
10	Prunus spinosa	Blackthorn	120-150cm tall, 3x transplanted, bare root	1 per 200'

Plant all plants within the tree compatibility boundary. However, do not plant 10-15% of the same species together in any one group. Ensure that there is a good mix of sizes as well as species. Do not exceed 15 of the same size together.

HEDGEROWS

S. QP No.	Species	Common Name	Height	Specification
H1	Prunus spinosa	Blackthorn	2.0m	120-150cm tall, 3x transplanted, bare root
H2	Prunus spinosa	Blackthorn	2.0m	120-150cm tall, 3x transplanted, bare root
H3	Prunus spinosa	Blackthorn	2.0m	120-150cm tall, 3x transplanted, bare root
H4	Prunus spinosa	Blackthorn	2.0m	120-150cm tall, 3x transplanted, bare root

GRASS SEEDING + MEADOW MIX

Ref	Species	Specification
GA	Mix A/B (Boscage and Embankment) by General Amenity	Seed at 20g/m ² of all established, well developed swards, mix 2m to 10m wide and 10-15m long.
GA	Mix A/B (Boscage and Embankment) by General Amenity	Seed at 20g/m ² of all established, well developed swards, mix 2m to 10m wide and 10-15m long.

INDIVIDUAL TREES

Ref	Species	Common Name	Height	Spec	Specification	Plt. Rate
T1	Prunus spinosa	Blackthorn	1.5m - 2.0m	120-150cm tall	3x transplanted, bare root	1 per 200'
T2	Prunus spinosa	Blackthorn	1.5m - 2.0m	120-150cm tall	3x transplanted, bare root	1 per 200'
T3	Prunus spinosa	Blackthorn	1.5m - 2.0m	120-150cm tall	3x transplanted, bare root	1 per 200'
T4	Prunus spinosa	Blackthorn	1.5m - 2.0m	120-150cm tall	3x transplanted, bare root	1 per 200'

SHRUB PLANTING

Ref	Species	Common Name	Density	Height	Specification	Plt. Rate
SB	Calluna vulgaris	Calluna heath	1 per m ²	40-60cm	Healthy, 16-18 weeks	1 per 200'
SB	Calluna vulgaris	Calluna heath	1 per m ²	40-60cm	Healthy, 16-18 weeks	1 per 200'
SB	Calluna vulgaris	Calluna heath	1 per m ²	40-60cm	Healthy, 16-18 weeks	1 per 200'
SB	Calluna vulgaris	Calluna heath	1 per m ²	40-60cm	Healthy, 16-18 weeks	1 per 200'

Planting must be of high quality plants as far as possible and all plants to be planted by the contractor. Confirmation of all planting must come from nurseries certified as being Tree Trust and/or British Planting Stock. All plants must be planted in accordance with the British Standard BS 5831:2010.





Labels



Feedback

100 feet 25 m



Labels



Feedback

100 feet 25 m



PANEGUET ROAD
POST OFFICE CAR PARK