



Legend

-  Existing 30mph Speed Limit
-  Existing 40mph Speed Limit Changed to 30mph Speed Limit
-  Existing 60mph Speed Limit Changed to 30mph Speed Limit

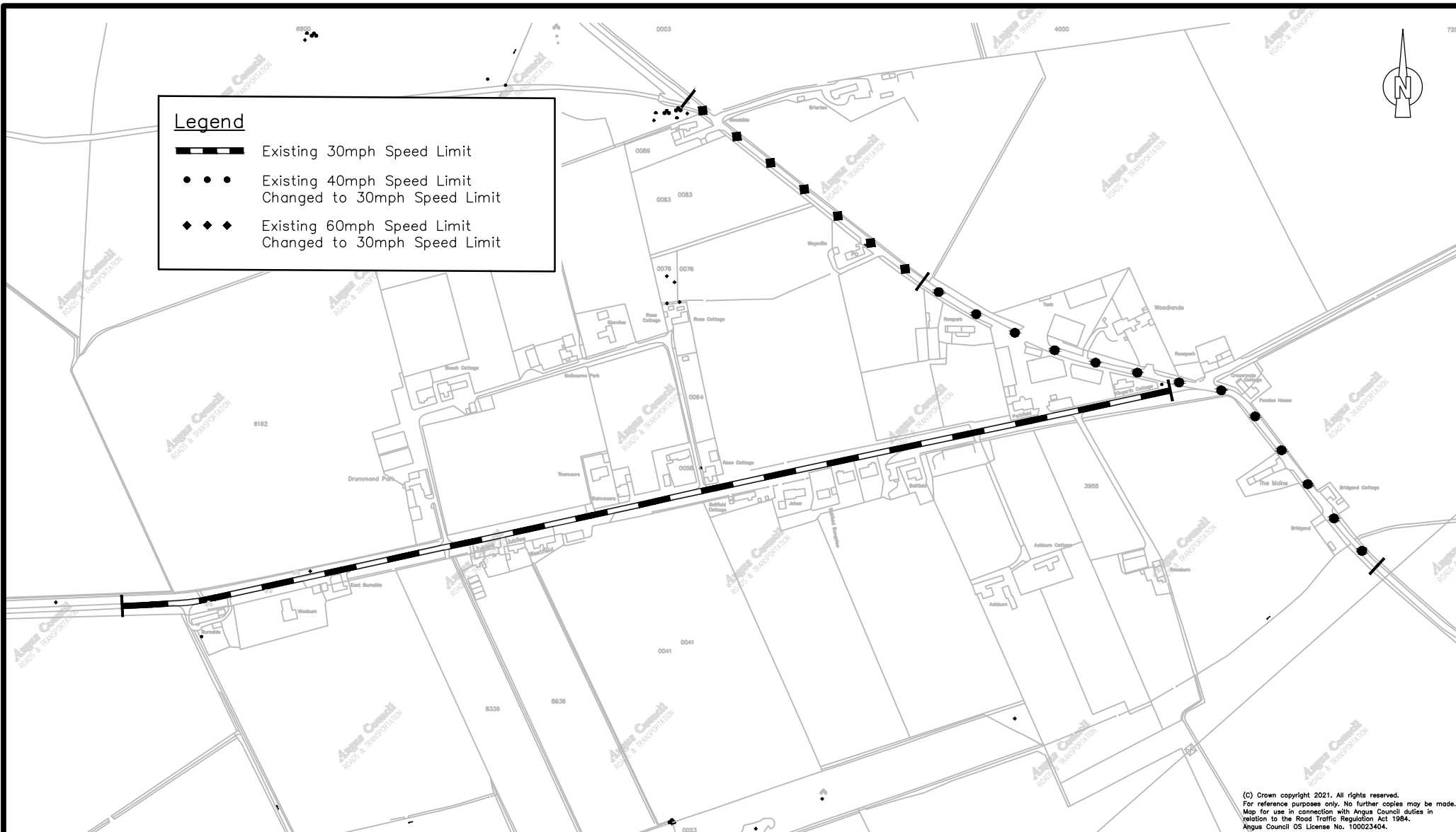

(C) Crown copyright 2021. All rights reserved.
 For reference purposes only. No further copies may be made.
 Map for use in connection with Angus Council duties in relation to the Road Traffic Regulation Act 1984.
 Angus Council OS License No. 100023404.

Drawing Size: A4	Plotting Scale: 1:5000	Status: FINAL
Drawn by: AB	Checked By: AGG	Approved By: CH
Date: 16/11/21	Date: 16/11/21	Date: 16/11/21

Issue: **MADE**

Angus Council
 ROADS & TRANSPORTATION
 Engineer-Service Leader, Roads & Transportation

Traffic Section
 Angus House
 Orchardbank Business Park
 Forfar
 DD8 1AN

Tel: 03452 777778
 Email: roads@angus.gov.uk

Drawing Title:
THE ANGUS COUNCIL (SPEED LIMITS AT LITTLE BRECHIN) (VARIATION) ORDER 2021

Rev.	Date	Description	Drawn	Checked	Approved	Issue: MADE	Path & Filename:	Project No: 134000000	Drawing No: C30/LB/21/1	Revision:
------	------	-------------	-------	---------	----------	--------------------	------------------	---------------------------------	-----------------------------------	-----------