

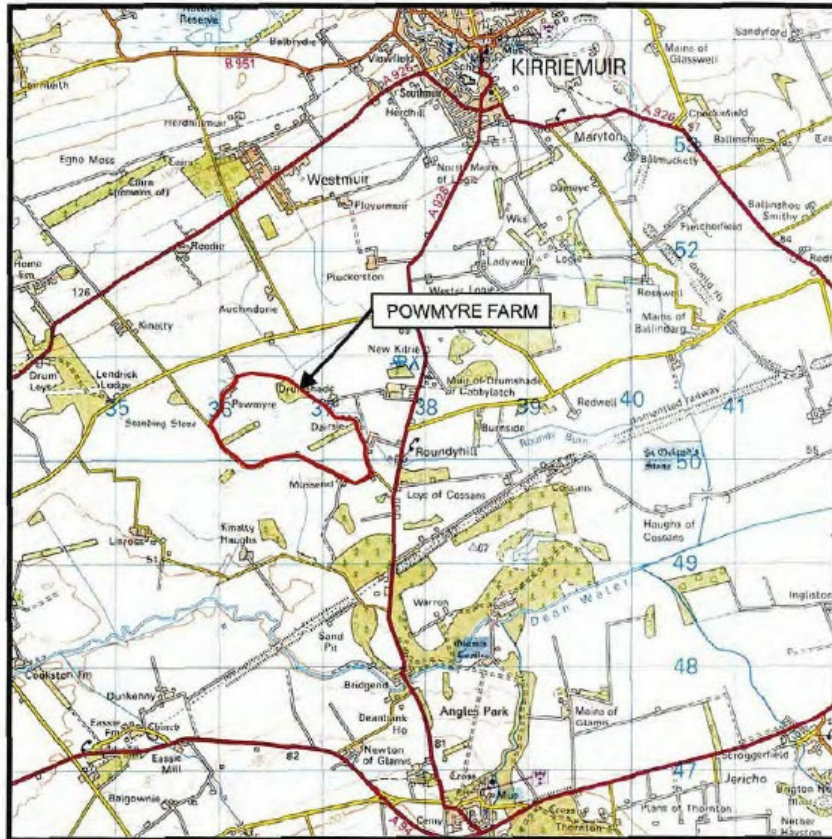

Item 7

Planning application: 21/00769/FULM

Powmyre Quarry, Roundyhill



REPRODUCED FROM THE ORDNANCE SURVEY MAP WITH THE PERMISSION OF THE CONTROLLER OF HER MAJESTY'S STATIONERY OFFICE. CROWN COPYRIGHT. LICENCE NUMBER AL51168AJ0001

| | |
|--|-----------------|
| CLIENT | |
|  | |
| PROJECT | |
| SITE POWMYRE FARM | |
| DRAWING SITE LOCATION PLAN | |
| DRAWING No. | DATE MAY 2003 |
| 4810-11-1 | SCALE 1:50,000 |
| | DRAWN BY GJV |
| PROJECT No. 4D/275/019 | FILE POWMYRESLP |

 WHEELLEY RIDGE,
WHEELLEY ROAD,
ALVECHURCH,
WORCS. B48 7DD
TEL: 0121 447 8040
FAX: 0121 447 8076
www.slrcountryside.co.uk



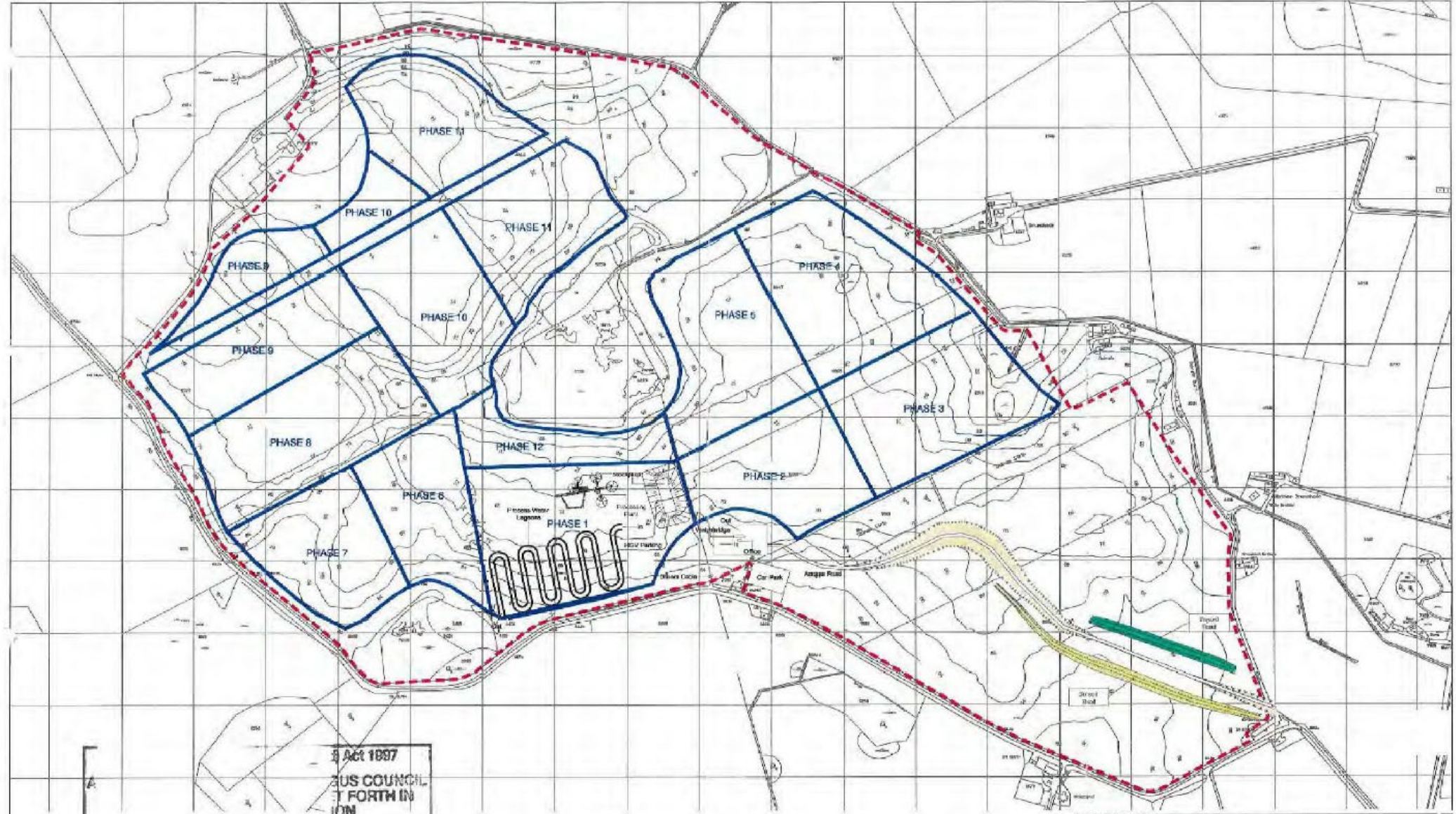

1897
 TOWN COUNCIL
 OF FORTH
 DIVISION

| | | |
|-------------------|---|--|
| A3 | Powmyre Quarry Aggregate Industries Phasing Plan | IronsideFarrar Town & Country Consultants Planning & Design 100-102 High Street Farnham, Surrey GU14 7AB Tel: 01253 853111 Fax: 01253 853122 www.ironsidefarrar.co.uk |
| | Project: Powmyre Quarry Client: Aggregate Industries Title: Phasing Plan Design By: JT Date: 23.05.09 Scale: 1:5,000 | Drawing No: 4810-4-01 |

Ironside Farrar Town & Country Consultants & Engineers

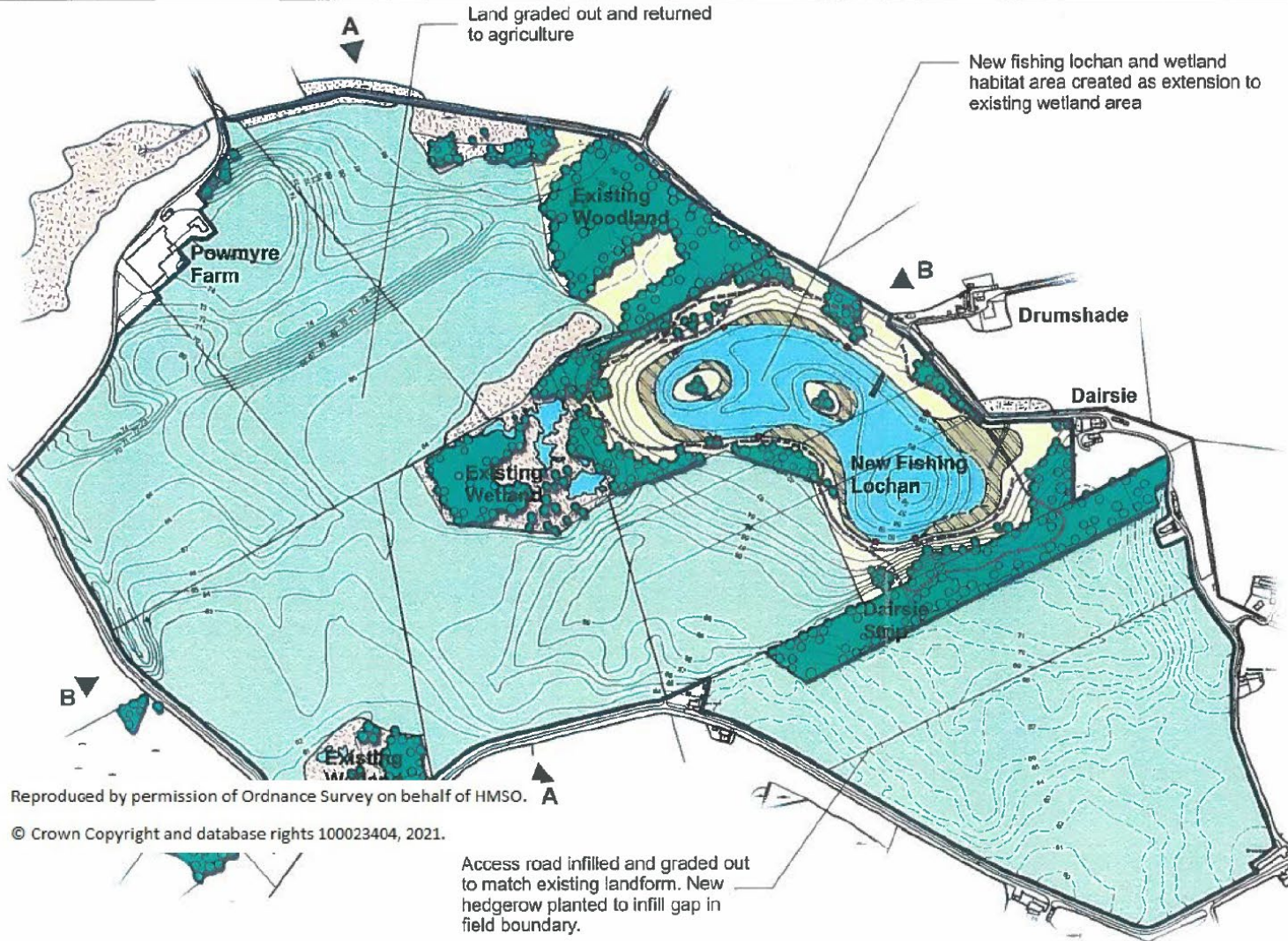

- Key**
- Existing / New Woodland Planting
 - Existing Wetland Area
 - Land Restored to Agriculture
 - Wildflower Meadow / Grassland
 - Emergent Vegetation (reed beds) in Shallow Water
 - Mown Grass Path
 - Fishing Platform

Town & Country Planning (Scotland) Act 1997

APPROVED ON BEHALF OF THE ANGUS COUNCIL
SUBJECT TO THE CONDITIONS SET FORTH IN
INTIMATION OF DECISION

Dated **- 8 FEB 2007**

Authorised Officer

0 100 200 400m

Reproduced by permission of Ordnance Survey on behalf of HMSO. © Crown Copyright and database rights 100023404, 2021.

Cross Sections
(Double scale of plan)

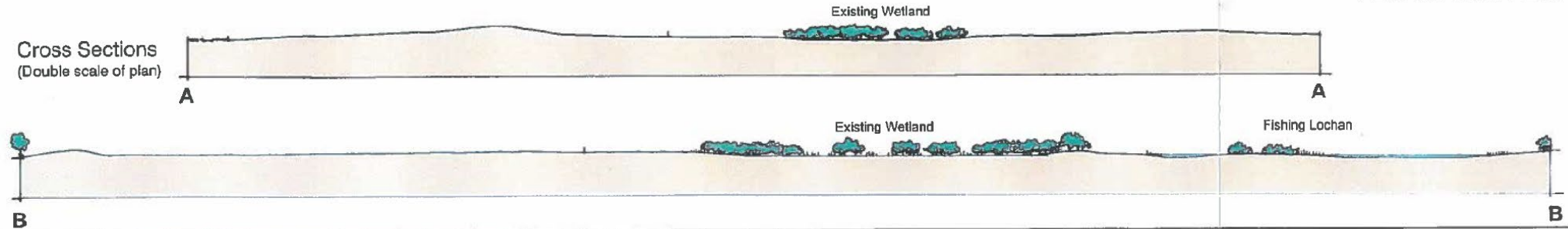

Reproduced by permission of Ordnance Survey on behalf of HMSO.
© Crown Copyright and database rights 100023404, 2021.

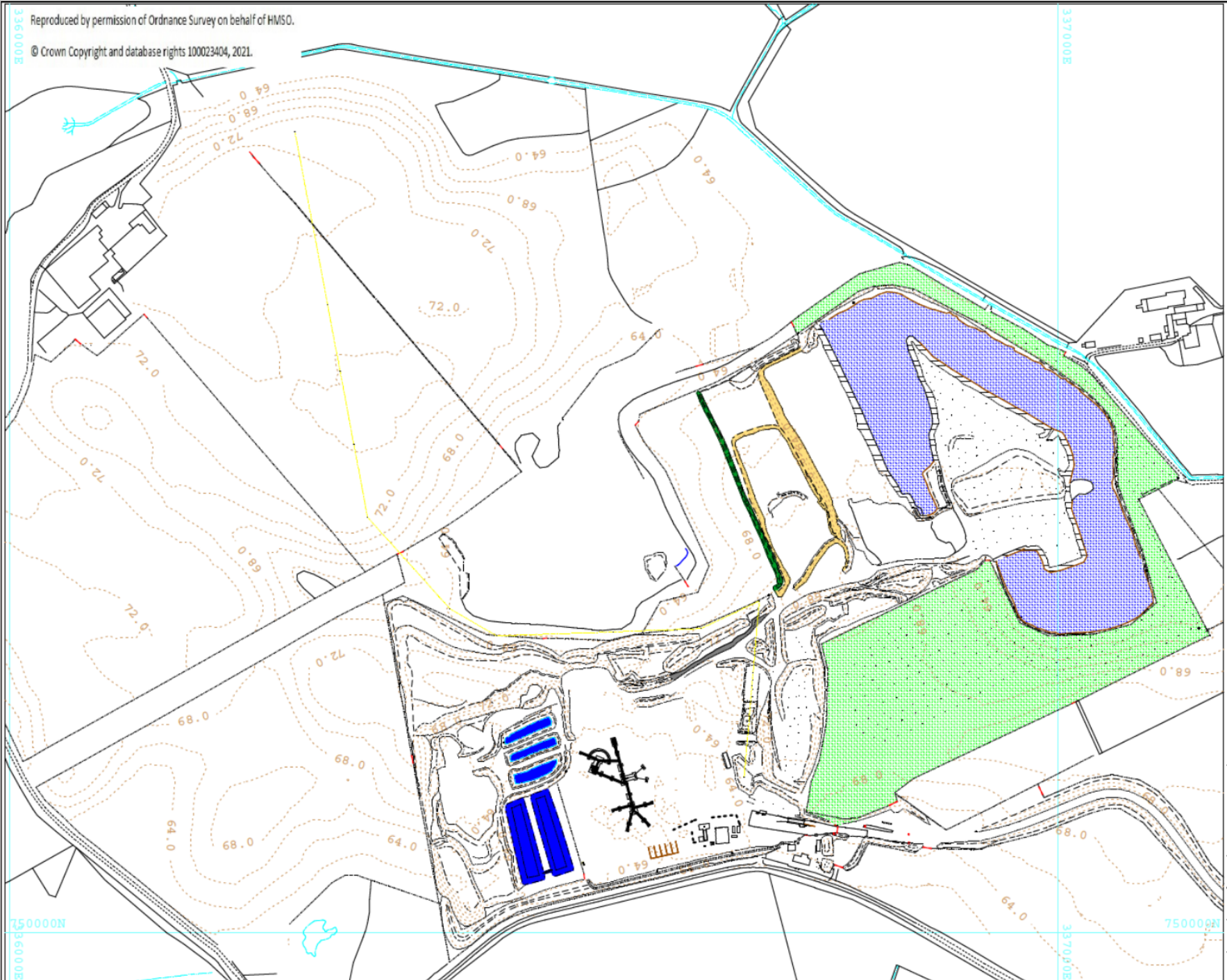

Breedon Northern Limited
Head Office
Chesterton Quarry
Marblehead, Anglesey
North Wales, Gwynedd
LL57 2JG
Tel: 01352 537600
www.breedon.co.uk

P03 Powmyre

Interim
Restoration Plan

| | |
|------------------------|----------------------------|
| Drawn By GJM | Date 10-SEP-2019 |
|------------------------|----------------------------|

| | |
|--------------------------|----------------------------------|
| Scale 1 : 5000 | Drawing No. 4810-10-32 |
|--------------------------|----------------------------------|







Powmyre Quarry

Viewpoint 1

View south from Auchindorie junction

Photosheet

Viewpoint Information

| | |
|------------------|---|
| Grid Reference | N751240 S336768 |
| Ground Height | 76m AOD |
| Viewer Height | 1.5m |
| Included Angle | 70° |
| Distance to Site | 460m |
| Viewing Distance | 320mm |
| Camera Used | Canon EOS 5DS (fixed 50mm focal length lens) |

Date / Time

16/04/2021 13:07

Paper

A3

Location Plan





Powmyre Quarry

Viewpoint 2

View west from Roundyhill

Photosheet

Viewpoint Information

| | |
|------------------|---|
| Grid Reference | N750539 S337896 |
| Ground Height | 73m AOD |
| Viewer Height | 1.5m |
| Included Angle | 70° |
| Distance to Site | 610m |
| Viewing Distance | 320mm |
| Camera Used | Canon EOS 5DS (fixed 50mm focal length lens) |

Date / Time

16/04/2021 14:05

Paper

A3

Location Plan



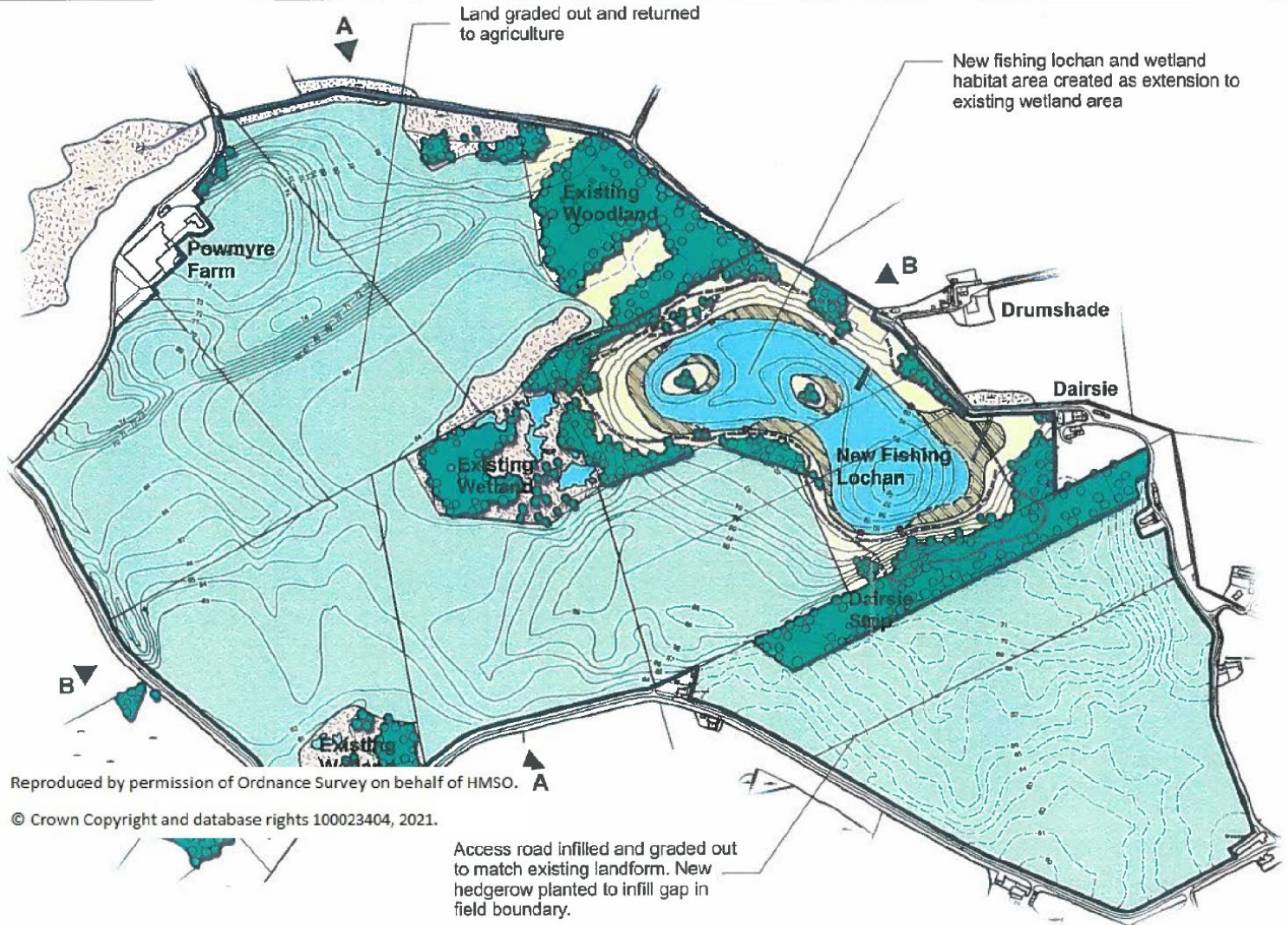

Reproduced by permission of Ordnance Survey on behalf of HMSO. © Crown Copyright and database rights 100023404, 2021.

Access road infilled and graded out to match existing landform. New hedgerow planted to infill gap in field boundary.

New fishing lochan and wetland habitat area created as extension to existing wetland area

Key

- Existing / New Woodland Planting
- Existing Wetland Area
- Land Restored to Agriculture
- Wildflower Meadow / Grassland
- Emergent Vegetation (reed beds) in Shallow Water
- Mown Grass Path
- Fishing Platform

Town & Country Planning (Scotland) Act 1997
APPROVED ON BEHALF OF THE ANGUS COUNCIL
SUBJECT TO THE CONDITIONS SET FORTH IN
INTIMATION OF DECISION

Dated **- 8 FEB 2007**

Authorised Officer

0 100 200 400m

DRAWING 4810-10-16 RESTORATION PLAN

Cross Sections
(Double scale of plan)

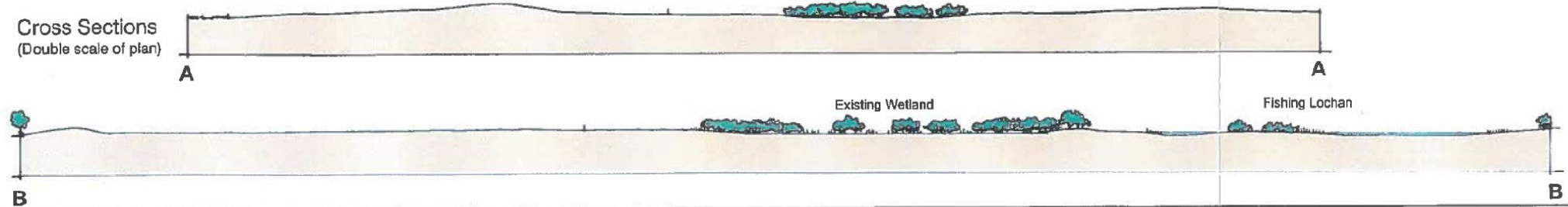

Blank