

Item 14

Proposal of application notice: 22/00294/PAN

Residential development of up to 90 houses, a farm shop, orchard, open space and associated works on land at Newtyle Road, Muirhead

Birkhill & Muirhead

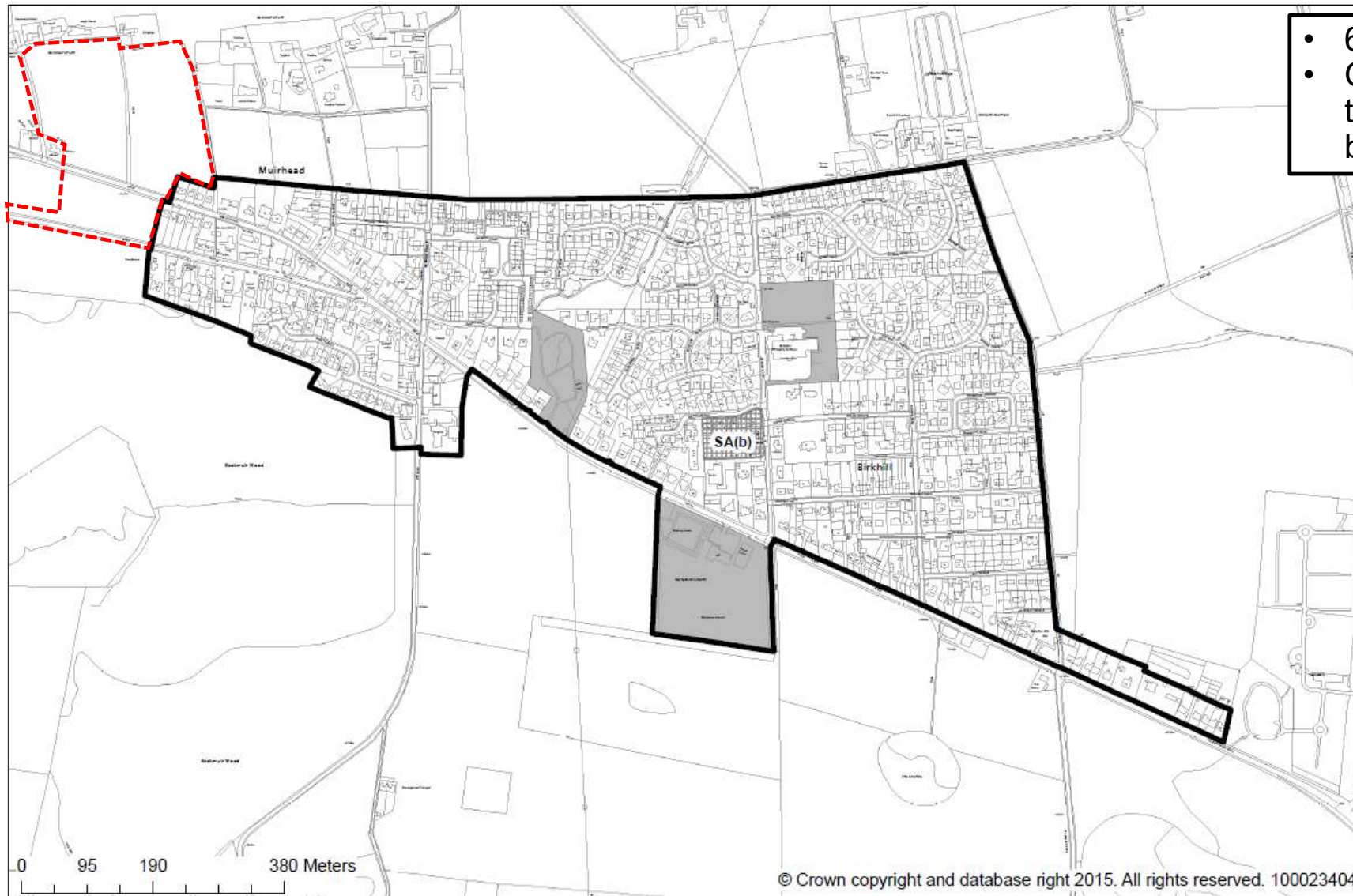

- 6.6HA
- Outwith but adjacent to development boundary

© Crown copyright and database right 2015. All rights reserved. 100023404.

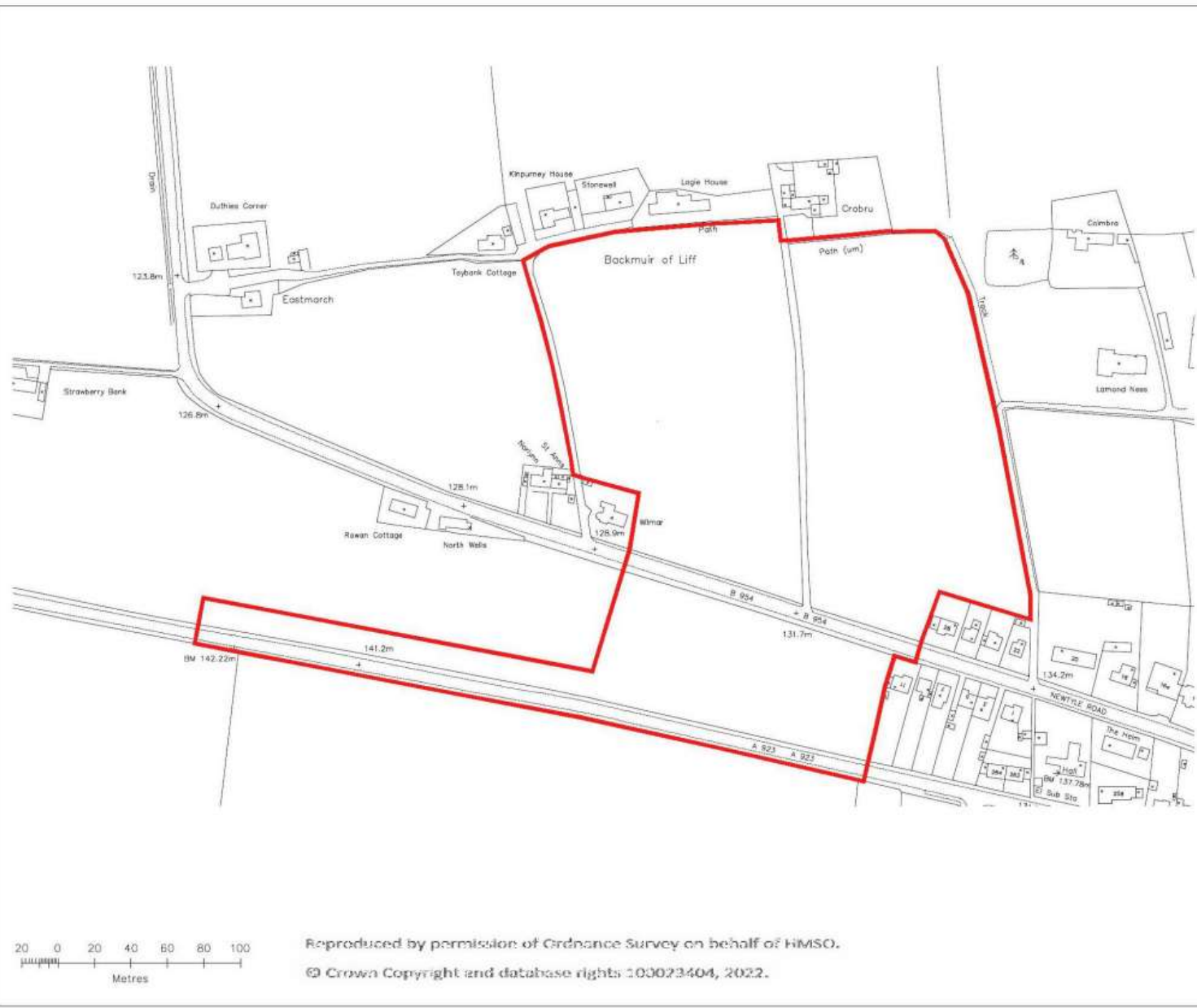

Reproduced by permission of Ordnance Survey on behalf of HMSO.
 © Crown Copyright and database rights 100023404, 2022.

THIS DOCUMENT IS THE PROPERTY OF EMA ARCHITECTS + MASTERPLANNERS. IT IS TO BE USED ONLY FOR THE PURPOSES SPECIFIED IN THE TITLE. IT IS NOT TO BE REPRODUCED, COPIED, OR TRANSMITTED IN ANY FORM OR BY ANY MEANS, WITHOUT THE WRITTEN PERMISSION OF EMA ARCHITECTS + MASTERPLANNERS. THE INFORMATION CONTAINED HEREIN IS PROVIDED AS IS, WITHOUT WARRANTY, REPRESENTATION, OR GUARANTEE. EMA ARCHITECTS + MASTERPLANNERS SHALL NOT BE LIABLE FOR ANY LOSS OR DAMAGE, INCLUDING CONSEQUENTIAL DAMAGES, ARISING FROM THE USE OF THIS DOCUMENT.

Item	Description	Area	Value
1	Area of the PAN boundary	6.61	10,000.00

— PAN BOUNDARY (6.61HA)



ema
 architects + masterplanners

42 CHARLOTTE SQUARE
 GLASGOW
 G2 8JG
 T: 0141 204 1000
 WWW.EMA-ARCHITECTS.CO.UK

MUIR HOMES LTD
 PROPOSED DEVELOPMENT
 EAST ADAMSTON
 MUIRHEAD

PAN APPLICATION BOUNDARY

Item	Description	Area	Value
1	Area of the PAN boundary	6.61	10,000.00

Members invited to identify any issues in addition to those listed at 4.9

Angus Council
 Comhairle Aonghais