

SAFETY, HEALTH AND ENVIRONMENTAL INFORMATION
In addition to the hazards/risks normally associated with the types of work detailed on this drawing, note the following:
CONSTRUCTION
1. UNDERGROUND STATUTORY UNDERTAKERS PLANT INTERACTION. 2. WORKING IN A FLOOD ZONE OR ADJACENT TO WATER. 3. INTERACTION WITH THE PUBLIC. 4. WORKING UNDER OR ADJACENT TO STRUCTURES. 5. ACCESS/EGRESS CONSTRAINTS.
MAINTENANCE/CLEANING
NONE
DECOMMISSIONING/DEMOLITION
NONE
It is assumed that all works will be carried out by a competent contractor working, where appropriate, to an approved method statement

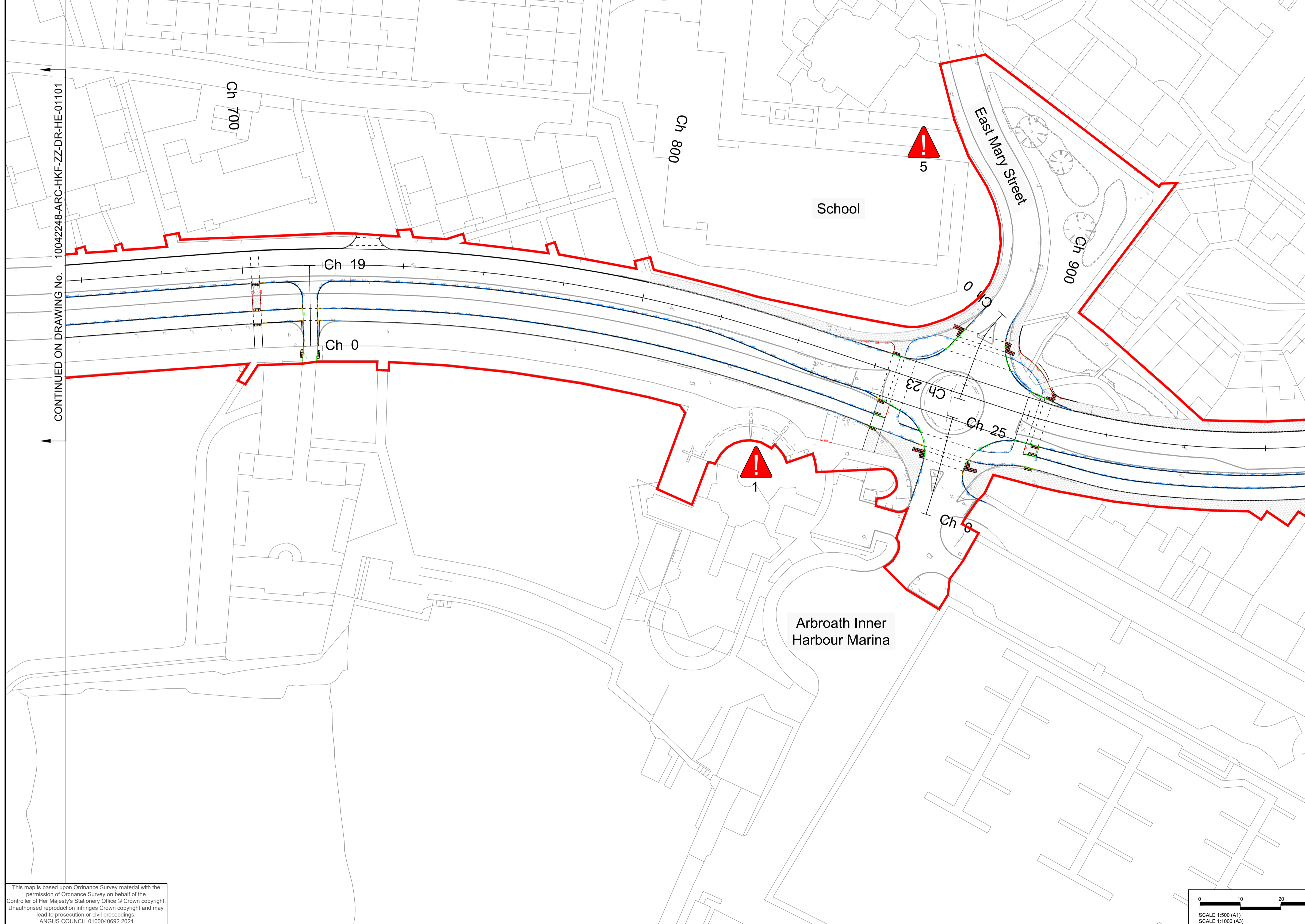

- NOTES:**
- THIS DRAWING SHALL BE READ IN CONJUNCTION WITH ALL OTHER DRAWINGS, SCHEDULES AND SPECIFICATIONS FOR THIS SCHEME.
 - DO NOT SCALE FROM THIS DRAWING.
 - ALL DIMENSIONS ARE IN METERS UNLESS OTHERWISE SPECIFIED.
 - DRAWING TO BE PRINTED IN COLOUR.
 - THE LOCATION OF STATUTORY UNDERTAKERS APPARATUS SHOULD BE PROVED BY THE CONTRACTOR BEFORE UNDERTAKING ANY EXCAVATION.
 - CONTRASTING COLOUR BLISTER AND CORDUROY TACTILE PAVING TO BE PROVIDED IN ACCORDANCE WITH DEPARTMENT OF TRANSPORT DOCUMENT 'GUIDANCE ON THE USE OF TACTILE PAVING SURFACES' (DECEMBER 2021)
 - ALL SERVICE COVERS TO BE RAISED OR LOWERED TO SUIT PROPOSED FOOTWAY / CARRIAGEWAY LEVELS.
 - BACK OF THE FOOTWAY LEVELS TO BE RETAINED.

KEY:

	F1 - PROPOSED STANDARD FOOTPATH: CONCRETE BLOCK PAVING, GREY
	F2 - PROPOSED ENHANCED PUBLIC REALM PAVING: DENFIND SANDSTONE
	F3 - PROPOSED SHARED SURFACE: SANDSTONE PAVING, HERRINGBONE PATTERN.
	PROPOSED ARTIFICIAL STONE TACTILE PAVING
	PROPOSED ARTIFICIAL STONE RED COLOURED TACTILE PAVING
	DR - DROPPER KERB
	ED - CONCRETE EDGING
	HBE - HALF BATTER KERB
	SP - SPLAYED KERB
	BN - BULLNOSE KERB
	REDLINE BOUNDARY

Rev	Date	Description	Prod.	Chk.	Rev.	App.
P01	29/03/23	FOR PRICING	RM	MS	KK	MS
P02	31/03/23	FOR PRICING	RM	KK	MS	MS
P03	29/09/23	FOR TENDER	RM	KK	MS	MS
P04	29/02/24	For Construction	RM	KK	MS	MS
C01	02/04/24	For Construction	RM	MS	WW	WW
C02	24/04/24	For Construction	RM	KK	MS	MS



Project: **Arbroath A Place for Everyone**

Site: A92 Westport, Arbroath, Angus

Client: Angus Council, Angus House, Sylvie Way, Orchardbank Business Park, Forfar, DD8 1AN, www.angus.gov.uk



Registered office: 80 Fenchurch Street, London EC3M 4BY

Coordinating office: 16th Floor, 103 Colmore Row, Birmingham B3 3AG, Tel: 44 (0)121 516 1818

www.arcadis.com © Copyright reserved

Drawing Title: **Arbroath - A Place for Everyone Detailed Design Kerbs Footways and Paved Areas Sheet 3 of 6**

Designated	Signed	Date
D. Bell	Digitally Signed	24/04/24
Producer	Signed	24/04/24
R. McComish	Digitally Signed	24/04/24
Checker	Signed	24/04/24
K. Kelly	Digitally Signed	24/04/24
Reviewed	Signed	24/04/24
M. Scott	Digitally Signed	24/04/24
Approved	Signed	24/04/24
M. Scott	Digitally Signed	24/04/24

Original Size: N/A	Grid: OS	Datum: AOD
Suitability Code: A1	Scale: 1:500	Project Number: 10042248

Brief Stage Complete Authorized and Accepted

Drawing Number: **10042248 - ARC - HKF ZZ - DR - HE - 01102** Revision: **C02**

This map is based upon Ordnance Survey material with the permission of Ordnance Survey on behalf of the Controller of Her Majesty's Stationery Office © Crown copyright. Unauthorised reproduction infringes Crown copyright and may lead to prosecution or civil proceedings. ANGUS COUNCIL 0100040692 2021

